

ESC 10

EXIT LIGHT WITH A LIGHT PLATE AND WITH A VIEWING DISTANCE OF 30 M,
FOR WALL MOUNTING

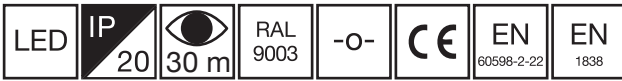

TW844 is a stylish light plate LED exit light with aluminium profile body, for wall mounting.

The luminaire can be used 1 sided as well as 2 sided. Long lasting leds are used as the luminaire's light source.

The pictogram of the luminaire is screen printed on the inside surface of the light plate.

DIMENSIONS

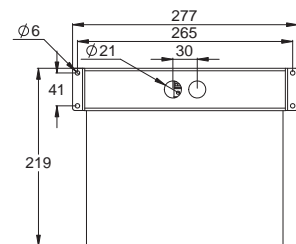
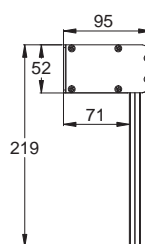
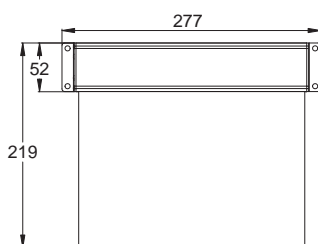

= Protection class of luminaire is 1 = Protection rating **Aalto** = Aalto Control compatible (incl. Lumi Test) = compliant with the 850 glow wire test
 = Protection class of luminaire is 2 = Colour of the body **M** = Self-contained luminaire with Lumi test self-testing **IC** = Compatible with Intelligent Controller
 = Protection class of luminaire is 3 = Viewing distance **Escap** = Self-contained luminaire with 1 h super capacitor backup **CBS** = Centrally supplied
 = Luminaire is suitable for through-wiring = LED as a light source **C** = Compatible with Tapsa Control Central Battery Unit and Local Controller

CENTRALLY SUPPLIED LUMINAIRES

24 V CENTRALLY SUPPLIED EXIT LIGHTS

Product code	Nominal supply voltage	Max input power	Operation mode	Temperature range	Electrical installation	Weight (kg)
TW84441W	24 V 50/60 Hz AC,DC	2 VA / 2,5 W	CBS	-30... +50°C	2 x 2,5 mm ² -o-	1,2

230 V CENTRALLY SUPPLIED EXIT LIGHTS

Product code	Nominal supply voltage	Max input power	Operation mode	Temperature range	Electrical installation	Weight (kg)
TW84451W	220-240 V, 50/60 Hz AC,DC	8,2 VA / 3,9 W	CBS	-30... +50°C	3 x 2,5 mm ² -o-	1,2



ADDRESSABLE 230 V CENTRALLY SUPPLIED EXIT LIGHTS



Product code	Nominal supply voltage	Max input power	Operation mode	Temperature range	Electrical installation	Weight (kg)
TW84451WK	220-240 V, 50/60 Hz AC,DC	8,3 VA / 4,6 W	CBS / C + IC	-30... +50°C	3 x 2,5 mm ² -o-	1,2



SEPARATELY ORDERED PICTOGRAMS (30 m)

Product code	Pictogram	Product description
PBV10302E		Down arrow, 2-sided
PBV10301E		Left/right arrow, 2-sided
PB026B		White label

Pictograms in the table are always 2-sided, e.g.  = right/left arrow

ACCESSORIES

Product code	Product description
TW77507B	Shock protecting cover (dimensions: X=320, Y=165, Z=305, A=340)

SHOCK PROTECTING COVER
TW77507B

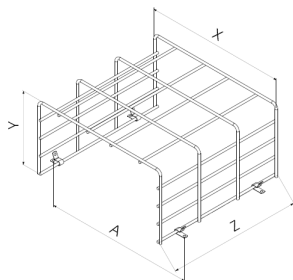

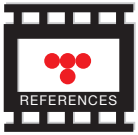

CASE Meriton Garden Hotel, restaurant Trofé, Tallinn, Estonia

Meriton Garden hotel's Trofé restaurant's menu is largely inspired by the Nordic food culture.

Both the hotel and the restaurant have Teknoware's self-contained exit and emergency lights with battery.