



# C57



## TECHNICAL DATA

C57

Length overall	16,73 m	54'9"
Length hull	16,16 m	53'1"
Length at waterline	15,50 m	50'9"
Beam overall	5,28 m	17'3"
Draft standard cast iron keel [approx.]	2,52 m	8'2"
Draft option cast iron keel as shallow keel [approx.]	1,99 m	6'5"
Displacement, standard keel	17.130 kg	37.765 lbs
Displacement, shallow keel	17.370 kg	38.294 lbs
Ballast shallow keel	5.550 kg	12.235 lbs
Ballast deep keel	5.310 kg	11.706 lbs
Engine, standard	Diesel, 59kW/80hp, sail drive	Diesel, 59kW/80hp, sail drive
Engine, upgrade	Diesel, 81kW/110hp, shaft drive	Diesel, 81kW/110hp, shaft drive
Fuel tank [approx.]	500 L	110 gal
Water tank [approx.]	650 L	143 gal
Sail Area	153 m <sup>2</sup> /149 m <sup>2</sup>	1.646 sq ft /1.603 sq ft
Self tacking Jib	60 m <sup>2</sup> /57 m <sup>2</sup>	645 sq ft /613 sq ft
Mainsail, standard	80 m <sup>2</sup>	861 sq ft
Mainsail, furling	76 m <sup>2</sup>	818 sq ft
Genoa	69 m <sup>2</sup>	743 sq ft
Gennaker	232 m <sup>2</sup>	2.497 sq ft
Code 0	123 m <sup>2</sup>	1.324 sq ft
Height of mast above water line [approx.]	24,26 m	79'6"
I	20,40 m	66'9"
J	6,55 m/6,20 m	21'4"/20'3"
P	20,00 m	73'9"
E	6,88 m	22'6"
CE Category	A	A
Design	Cossutti Yacht Design	Cossutti Yacht Design

TRIM LEVEL	BASE PRICE EX WORKS EXCL. VAT
HOLIDAY	409.500,00 €
STYLE	428.400,00 €

# LAYOUT

C57

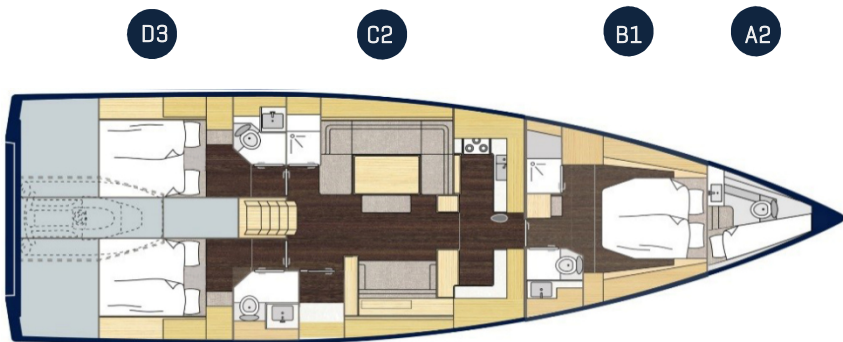
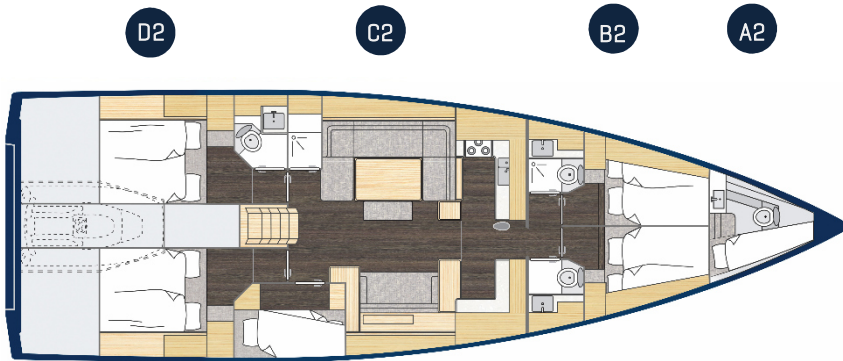
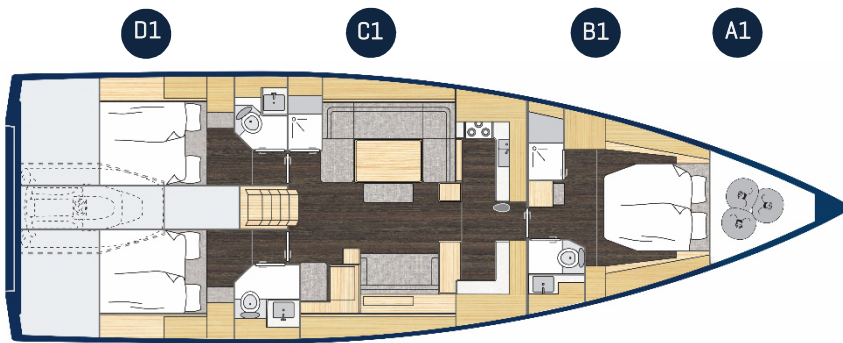

## STANDARD AUSSTATTUNG

C57

### Hull

Hull in sandwich construction

### Keel

L-shaped keel, cast iron, draft 2,52m

### Steering System

Twin wheel steering system  
Twin rudders

### Propulsion

Diesel engine, 59 kW / 80 hp, sail drive  
Mechanical throttle, mounted on steering pedestal, starboard  
3 blade fixed propeller

### Interior Layout

A1: Sail locker  
B1: Queen size "island" double berth, storage, separate head and shower stall  
C1: Salon incl. U shaped galley, dining area on port, lounge area and chart table on stb [only with D1]  
D1: 2 Twin cabins with "scissor" bed aft, incl. ensuite head and separate shower stall on port and separate head on stb [only with C1]  
E1: Storage space for toys and equipment under cockpit, access via cockpit floor hatch

### Interior Styling

"Classic" Mahogany interior, incl. "Elm" floor  
Laminate worktop surface in galley "brown stone"

### Upholstery

Upholstery "Vela" in salon  
Standard mattresses for all berths

### Interior Equipment

Fridge in galley, 110L, top loading  
3 burner stove with oven  
Salon dining table

### Plumbing System

40 L boiler  
70 L holding tank, per toilet  
Electric and manual bilge pump

### Electrical Systems

1 x engine battery, 12 V / 95 Ah, AGM  
2 x service batteries, 12 V / 2 x 95 Ah, AGM  
Battery charger, 40 Ah [3 channels]  
230 V socket in each cabin  
Country version EU

### Cockpit & Deck

Deck in sandwich construction, cockpit floor, side decks and coach roof with non-slip structure  
Bathing platform, electric  
Teak on cockpit benches and bathing platform  
Companion way with washboard and sliding hatch in acrylic glass, lockable  
Twin cockpit tables  
Flush hatches  
Dedicated life raft storage in cockpit floor  
Stainless steel steering wheels with leather cover

### Mooring & Anchoring

Stainless steel anchor arm with roller, fixed  
4 mooring cleats, stainless steel, fixed

### Standing & Running Gear

Standard keel stepped 2 spreaders mast, aluminium  
Above deck jib furler, manual  
Rod kicker  
Backstay adjuster, mechanical  
Midboom sheeting system  
Elvström Cruisetech Dacron mainsail & self-tacking jib

### Winches

2 x halyard winches, size 55, manual

TRIM LEVEL EQUIPMENT	HOLIDAY	STYLE	C57
<b>Hull</b>			
Hull colour signal white with dark blue cove- and waterline	■		
Hull colour signal white with silk grey cove- and waterline		■	
<b>Interior Styling</b>			
Upholstered headboard in front cabin [B1]		■	
Upholstered bed frames in front and aft cabins		■	
Fabric covered ceiling panels in salon		■	
Leather style covered chart table		■	
Leather style covered handrails		■	
<b>Cockpit &amp; Deck</b>			
Rope storage boxes, at helm position		■	
<b>Interior Equipment</b>			
Reading lights incl. USB charger, salon and cabins		■	
Handrail on ceiling in stainless steel with leather cover		■	
<b>Electrical Systems</b>			
Digital Switching System incl. 12" multifunction display at chart table with GPS function	■	■	

## SAIL READY PACKAGES

	HOLIDAY	STYLE	Price excl. VAT	C57
<b>SAIL READY PACK "HOLIDAY" (HP)</b>	○	—	<b>13.090,00 €</b>	<input type="checkbox"/>
2 Additional service batteries, 12 V / 2 x 95 Ah, AGM				
Guard rail exit, both sides				
Anchor windlass, electrical				
"Delta" Anchor, 32 kg, incl. Chain (10 mm, 50 m), galvanized				
Courtesy lights in salon				
Curtains for coachroof and hull windows				
Blinds incl. mosquito nets for hatches in salon and cabins				
2 vents on deck hatches				
LED lights in salon and cabins				
Mooring kit (8 fenders and 4 mooring lines)				
Reading lights incl. USB charger, salon and cabins				
Handrail on ceiling in stainless steel				
Stainless steel bow protection				
Cockpit shower with cold and warm water				
<b>UPGRADES SAIL READY PACK "HOLIDAY" (HP-U)</b>				
Tunnel bow thruster incl. 2 x 95 Ah battery	○	—	6.900,00 €	<input type="checkbox"/>
Teak on cockpit bottom	○	—	4.750,00 €	<input type="checkbox"/>
Bimini top	○	—	4.350,00 €	<input type="checkbox"/>
2 x halyard winches, size 65, electrical	○	—	6.300,00 €	<input type="checkbox"/>
Esthec on cockpit benches and bathing platform	○	—	2.400,00 €	<input type="checkbox"/>
<b>SAIL READY PACK "STYLE" (SP)</b>	—	○	<b>27.190,00 €</b>	<input type="checkbox"/>
Tunnel bow thruster incl. 2 x 95 Ah battery				
Teak on cockpit bottom				
2 Additional service batteries, 12 V / 2 x 95 Ah, AGM				
Guard rail exit, both sides				
Anchor windlass with capstans, electrical				
"Delta" Anchor, 32 kg, incl. Chain (10 mm, 50 m), galvanized				
Courtesy lights in salon and cockpit				
Curtains for coachroof and hull windows				
Blinds incl. mosquito nets for hatches in salon and cabins				
2 vents on deck hatches				
LED lights in salon and cabins				
Mooring kit (8 fenders and 4 mooring lines)				
Ambient lights in salon and cabins, dimmable				
Extractor hood in galley				
2 x halyard winches, size 65, manual				
2 lowerable cockpit tables convertible in sun bathing area, electric				
Cockpit shower with cold and warm water				
<b>UPGRADE SAIL READY PACK "STYLE" (SP-U)</b>				
Bow thruster incl. 2 x 95 Ah battery, retractable (Upgrade to bow thruster tunnel)	—	○	8.800,00 €	<input type="checkbox"/>
"Delta" Anchor, 32 kg, incl. Chain (10mm, 50m), stainless steel	—	○	3.875,00 €	<input type="checkbox"/>
2 x halyard winches, size 65, electrical	—	○	5.050,00 €	<input type="checkbox"/>
Exclusive full standing height shower on transom	—	○	4.375,00 €	<input type="checkbox"/>
Esthec on cockpit benches and bathing platform (instead of teak)	—	○	2.400,00 €	<input type="checkbox"/>
Organizer at halyard winches	—	○	2.390,00 €	<input type="checkbox"/>
<b>PERFORMANCE PACKAGE (PP)</b>	—	○	<b>16.480,00 €</b>	<input type="checkbox"/>
GRP steering wheels, black or white				
Genoa tracks with pin stop cars				
Elvström Sport triradial laminate mainsail & self tacking jib				
2 x Race halyard winches, size 65, manual				
2 x Race secondary winches, size 65, manual				
Organizer at halyard winches				
<b>UPGRADES PERFORMANCE PACKAGE (PP-U)</b>				

GRP bowsprit (black or white / recommended for gennaker and code 0)	—	○	4.350,00 €	<input type="checkbox"/>
Bow thruster incl. 2 x 95 Ah battery, retractable	—	○	12.900,00 €	<input type="checkbox"/>
2 x Race halyard winches, size 65, electrical	—	○	5.050,00 €	<input type="checkbox"/>
<b>ENTERTAINMENT PACKAGES</b>	<b>HOLIDAY</b>	<b>STYLE</b>	<b>Price excl. VAT</b>	<b>C57</b>
<b>ENTERTAINMENT PACKAGE "BASIC"</b>	○	○	1.950,00 €	<input type="checkbox"/>
Fusion MS-AV755 unit incl. Bluetooth streaming, dual USB; Multi-Zone technology, at chart table, Radio with DVD player function and colour display with 2 speakers in salon and cockpit, remote control in cockpit, connected with NMEA Network				
2 x Fusion high end speakers in salon				
2 x Fusion high end speakers in cockpit, watertight				
Fusion MS-NRX 300i remote control in cockpit				
Fusion wireless link				
<b>UPGRADES ENTERTAINMENT PACKAGE "BASIC"</b>				
Fusion MS-RA 205 unit incl. 2x Fusion high end speakers in owner's cabin (B1 only)	—	○	950,00 €	<input type="checkbox"/>
TV preparation in salon incl. lifting mechanism	○	○	1.880,00 €	<input type="checkbox"/>

<b>NAVIGATION PACKAGES</b>	<b>HOLIDAY</b>	<b>STYLE</b>	<b>Price excl. VAT</b>	<b>C57</b>
<b>NAVIGATION PACKAGE "BASIC"</b>	○	—	5.750,00 €	<input type="checkbox"/>
2 x B&G Triton <sup>®</sup> digital displays (one per helm station)				
B&G Zeus <sup>®</sup> 7" chart plotter (at stb helm station)				
B&G V60 VHF radio and AIS receiver at chart table incl. cabling and antenna				
<b>NAVIGATION PACKAGE „ADVANCED“</b>	○	○	16.450,00 €	<input type="checkbox"/>
2 x Instrument console (one per helm station)				
4 x B&G Triton <sup>®</sup> digital displays (2 per helm station)				
2 x B&G Zeus <sup>®</sup> S 9" chart plotter (one per helm station)				
B&G V60 VHF radio and AIS receiver at chart table incl. cabling and antenna				
B&G H60 wireless remote handset				
B&G Autopilot				
B&G Autopilot control unit (at stb helm station)				
B&G WR10 wireless remote control for autopilot				
GoFree wireless link				
<b>NAVIGATION PACKAGE „PREMIUM“</b>	—	○	23.400,00 €	<input type="checkbox"/>
2 x Instrument console (one per helm station)				
2 x B&G H5000 graphic displays (one per helm station)				
2 x B&G Zeus <sup>®</sup> S 12" chart plotter (one per helm station)				
B&G V60 VHF radio and AIS receiver at chart table incl. cabling and antenna				
B&G H60 wireless remote handset				
B&G Autopilot				
2 x B&G H5000 Autopilot control unit (one per helm station)				
B&G H5000 Hydra computer				
NMEA engine information interface for chart plotter				
B&G WR10 wireless remote control for autopilot				
GoFree wireless link				
<b>UPGRADES ELECTRONIC NAVIGATION PACKAGES</b>				
B&G 4G radar	○	○	3.250,00 €	<input type="checkbox"/>
B&G ForwardScan	—	○	1.550,00 €	<input type="checkbox"/>
B&G NAIS 400 AIS Class B Transponder	○	○	1.350,00 €	<input type="checkbox"/>
B&G WR10 wireless remote control for autopilot (only with Navigation Pack)	○	○	580,00 €	<input type="checkbox"/>

<b>INDIVIDUAL OPTIONS</b>	<b>HOLIDAY</b>	<b>STYLE</b>	<b>Price excl. VAT</b>	<b>C57</b>
<b>HULL/KEEL</b>				
Hull colour silk grey with white cove- and waterline	○	○	5.990,00 €	<input type="checkbox"/>
Hull colour signal white with dark blue cove- and waterline	■	○	1.590,00 €	<input type="checkbox"/>

Hull colour signal white with silk grey cove- and waterline	○	■	1.590,00 €	<input type="checkbox"/>
L-shaped keel, cast iron, shallow draft 1,99m	○	○	3.450,00 €	<input type="checkbox"/>
<b>PROPULSION</b>				
Diesel, 81 kW / 110 hp, shaft drive	○	○	4.850,00 €	<input type="checkbox"/>
Engine throttle control, mounted on stb instrument console, electronic [available only with instrument console in Navigation Packages "ADVANCED" or "PREMIUM"]	○	○	4.100,00 €	<input type="checkbox"/>
2 <sup>nd</sup> electronic engine throttle, mounted on instrument console portside [only available with engine control on stb]	○	○	2.900,00 €	<input type="checkbox"/>
3 blade folding propeller	○	○	2.350,00 €	<input type="checkbox"/>
Stern thruster incl. 2 x 95 Ah battery, retractable [only with bow thruster retractable]	—	○	15.700,00 €	<input type="checkbox"/>
<b>INTERIOR LAYOUT</b>				
A2: Crew cabin with sink, toilet and storage space, 25 L holding tank	○	○	4.020,00 €	<input type="checkbox"/>
B2: 2 double cabins with flex bulkhead, incl. Storage and 2 heads	○	○	4.700,00 €	<input type="checkbox"/>
C2: Salon incl. galley, dining area on port and lounge area on stb [only with D2, D3]	○	○	no charge	<input type="checkbox"/>
D2: 2 twin cabins aft, incl. separate head and shower stall on port and bunk cabin stb [only with C2]	○	○	1.450,00 €	<input type="checkbox"/>
D3: 2 twin cabins aft, incl. separate head and shower stall on port and utility room stb [only with C2]	○	○	1.450,00 €	<input type="checkbox"/>
E2: Full size dinghy garage longitudinal [max. 2,8 m jet tender]	○	○	4.630,00 €	<input type="checkbox"/>
Additional bunk bed for A2 layout [180 cm]	○	○	1.950,00 €	<input type="checkbox"/>
Dining table, lowerable, convertible into double berth incl. cushion, electrical	○	○	3.050,00 €	<input type="checkbox"/>
2 Director's chair [replacing bench in salon]	—	○	1.730,00 €	<input type="checkbox"/>
<b>INTERIOR STYLING [according to BAVARIA Style Guide]</b>				
Interior wood colour Mahogany "Classic"	■	■	Standard	<input type="checkbox"/>
Interior wood colour White Oak "Club"	○	○	5.900,00 €	<input type="checkbox"/>
Interior wood colour Walnut "Elegant"	○	○	6.400,00 €	<input type="checkbox"/>
Floor "Elm"	■	■	Standard	<input type="checkbox"/>
Floor "Wenge"	○	○	990,00 €	<input type="checkbox"/>
Floor "Ocean Line"	○	○	1.690,00 €	<input type="checkbox"/>
Laminate worktop surface in galley "Pure White stone"	○	—	380,00 €	<input type="checkbox"/>
Solid worktop surface in galley "Gravel"	—	○	2.990,00 €	<input type="checkbox"/>
Solid worktop surface in galley "Crispy Milk"	—	○	3.190,00 €	<input type="checkbox"/>
<b>INDIVIDUAL OPTIONS</b>	<b>HOLIDAY</b>	<b>STYLE</b>	<b>Price excl. VAT</b>	<b>C57</b>
<b>UPHOLSTERY [according to BAVARIA Style Guide]</b>				
Upholstery "Nautilus" in salon	—	○	1.390,00 €	<input type="checkbox"/>
Upholstery "Opus" in salon, artificial leather	○	○	1.550,00 €	<input type="checkbox"/>
Upholstery "Savoy" in salon, leather	—	○	5.450,00 €	<input type="checkbox"/>
Luxury cold foam mattress with memory top incl. box springs for all berths	○	○	3.650,00 €	<input type="checkbox"/>
<b>COCKPIT UPHOLSTERY [according to BAVARIA Style Guide]</b>				
Cockpit cushions incl. backrests and 6 scatter cushions	—	○	4.250,00 €	<input type="checkbox"/>
Sun bed cushions on coachroof incl. headrest and cup holders	○	○	1.890,00 €	<input type="checkbox"/>
Sun bed cushions on foredeck incl. headrest and cup holders	○	○	1.970,00 €	<input type="checkbox"/>
<b>DECK FLOORING</b>				
Teak on cockpit bottom	○	○	4.850,00 €	<input type="checkbox"/> HP-U, SP
Teak on side decks	○	○	17.990,00 €	<input type="checkbox"/>
Teak on coachroof	—	○	6.750,00 €	<input type="checkbox"/>
Esthec "Classic" or "Trend" on cockpit floor	○	○	5.150,00 €	<input type="checkbox"/>
Esthec "Classic" or "Trend" on side decks	○	○	18.450,00 €	<input type="checkbox"/>
Esthec "Classic" or "Trend" on coachroof	—	○	7.100,00 €	<input type="checkbox"/>
<b>COCKPIT &amp; DECK</b>				
GRP steering wheels, black or white	○	○	1.720,00 €	<input type="checkbox"/> PP
2 lowerable cockpit tables convertible in sun bathing area, electric	—	○	4.070,00 €	<input type="checkbox"/> SP
Drawer fridge incl. compressor at wet bar, 20 L [only in combination with E2 and BBQ]	○	○	1.450,00 €	<input type="checkbox"/>
BBQ [gas] with sink and water tap in wet bar [only in combination with E2]	○	○	2.300,00 €	<input type="checkbox"/>
Guard rail exit, both sides	○	○	1.250,00 €	<input type="checkbox"/> HP,SP
Guard rail exit ladder, aluminium	○	○	690,00 €	<input type="checkbox"/>
Full standing height shower on transom	—	○	3.820,00 €	<input type="checkbox"/> SP-U
Teak pushpit seats, foldable	—	○	1.250,00 €	<input type="checkbox"/>
<b>HOODS [according to BAVARIA Style guide]</b>				

Bimini top	<input type="radio"/>	<input type="radio"/>	4.450,00 €	<input type="checkbox"/>	HP-U
Bimini top incl. LED overhead lighting	<input type="radio"/>	<input type="radio"/>	5.300,00 €	<input type="checkbox"/>	
Sprayhood with handhold	<input type="radio"/>	<input type="radio"/>	3.250,00 €	<input type="checkbox"/>	
<b>BATHING PLATFORM &amp; DINGHY</b>					
Canvas dinghy garage cover (according to BAVARIA Style Guide)	—	<input type="radio"/>	800,00 €	<input type="checkbox"/>	
Tender launching system (incl. rollers and electrical winch, only with E2 dinghy garage)	<input type="radio"/>	<input type="radio"/>	4.950,00 €	<input type="checkbox"/>	
Wireless remote control for bathing platform	<input type="radio"/>	<input type="radio"/>	1.390,00 €	<input type="checkbox"/>	
12 V air compressor at transom for dinghy or toys (only with E2 Layout)	<input type="radio"/>	<input type="radio"/>	810,00 €	<input type="checkbox"/>	
<b>MOORING &amp; ANCHORING</b>					
6 mooring cleats, aluminum, retractable	—	<input type="radio"/>	4.250,00 €	<input type="checkbox"/>	
2 mooring cleats midship, stainless steel, fixed	<input type="radio"/>	<input type="radio"/>	250,00 €	<input type="checkbox"/>	
Stainless steel bow protection	<input type="radio"/>	<input type="radio"/>	470,00 €	<input type="checkbox"/>	HP
"Delta" Anchor, 32 kg, incl. Chain (10 mm, 50 m), galvanized	<input type="radio"/>	<input type="radio"/>	1.390,00 €	<input type="checkbox"/>	HP, SP
"Delta" Anchor, 32 kg, incl. Chain (10 mm, 50 m), stainless steel	—	<input type="radio"/>	4.150,00 €	<input type="checkbox"/>	SP-U
Anchor windlass with capstans, electrical, as an upgrade to "SAIL READY PACK "STYLE"	<input type="radio"/>	<input type="radio"/>	1.250,00 €	<input type="checkbox"/>	
<b>SAFETY</b>					
LFS - safety package	<input type="radio"/>	<input type="radio"/>	310,00 €	<input type="checkbox"/>	
Life saving collar with attachment and life line at pushpit	<input type="radio"/>	<input type="radio"/>	280,00 €	<input type="checkbox"/>	
<b>STANDING &amp; RUNNING GEAR</b>					
Carbon performance mast, boom and spreaders incl. rod rigging	—	<input type="radio"/>	on request	<input type="checkbox"/>	
Composite "V" boom incl. sail cover (instead of std boom)	—	<input type="radio"/>	on request	<input type="checkbox"/>	
Mainsail furling system incl. upgrade to furling mainsail (not available for carbon rigs)	<input type="radio"/>	<input type="radio"/>	3.950,00 €	<input type="checkbox"/>	
Mast step	<input type="radio"/>	<input type="radio"/>	650,00 €	<input type="checkbox"/>	
Elvström Duratech Dacron (HD) mainsail & self-tacking jib	<input type="radio"/>	—	7.429,00 €	<input type="checkbox"/>	
Elvström mainsail & self-tacking jib - Sporttech triradial laminate instead of standard	<input type="radio"/>	<input type="radio"/>	9.727,00 €	<input type="checkbox"/>	PP
Elvström genoa 106% - Cruisetech Dacron (only with genoa tracks)	—	<input type="radio"/>	4.665,00 €	<input type="checkbox"/>	
Elvström genoa 106% - Duratech (only with genoa tracks)	<input type="radio"/>	—	5.350,00 €	<input type="checkbox"/>	
Elvström genoa 106% - Sporttech (only with genoa tracks)	—	<input type="radio"/>	7.060,00 €	<input type="checkbox"/>	
Genoa tracks with pin stop cars	<input type="radio"/>	<input type="radio"/>	1.750,00 €	<input type="checkbox"/>	PP
Fully battened mainsail with MDS-system, incl. 2 reefs, offshore-quality (replacing standard mainsail)	<input type="radio"/>	<input type="radio"/>	1.250,00 €	<input type="checkbox"/>	
Elvström gennaker incl. snuffer and gennaker gear (halyard, sheets, blocks, halyard clutch and pad eye)	<input type="radio"/>	<input type="radio"/>	7.370,00 €	<input type="checkbox"/>	
Elvström gennaker incl. Selden top down furler and Gennaker gear (halyard, sheets, blocks, halyard clutch and pad eye for gennaker tack)	—	<input type="radio"/>	8.750,00 €	<input type="checkbox"/>	
Elvström Code 0 incl. Selden CX furling system and gear (halyard, sheets, blocks, halyard clutch and pad eye for code 0 tack / only with bowsprit)	—	<input type="radio"/>	8.344,00 €	<input type="checkbox"/>	
Lazy bag with lazy jacks for mainsail (according to BAVARIA Style guide)	<input type="radio"/>	<input type="radio"/>	1.550,00 €	<input type="checkbox"/>	
Spreader lights, 4 pcs.	—	<input type="radio"/>	1.450,00 €	<input type="checkbox"/>	
GRP bowsprit (black or white / recommended for gennaker and code 0)	—	<input type="radio"/>	4.350,00 €	<input type="checkbox"/>	PP-U
Backstay adjuster, hydraulic	<input type="radio"/>	<input type="radio"/>	2.750,00 €	<input type="checkbox"/>	
Organizer at halyard winches	—	<input type="radio"/>	2.330,00 €	<input type="checkbox"/>	SP-U, PP
<b>WINCHES</b>					
2 x halyard winches, size 65, manual	<input type="radio"/>	<input type="radio"/>	2.150,00 €	<input type="checkbox"/>	SP
2 x halyard winches, size 65, electrical	<input type="radio"/>	<input type="radio"/>	6.950,00 €	<input type="checkbox"/>	HP-U/SP-U
2 x genoa/gennaker/code 0 winches, size 55, manual	<input type="radio"/>	<input type="radio"/>	2.950,00 €	<input type="checkbox"/>	
2 x genoa winches, size 65, manual	—	<input type="radio"/>	3.250,00 €	<input type="checkbox"/>	
2 x genoa winches, size 65, electrical	—	<input type="radio"/>	6.950,00 €	<input type="checkbox"/>	

## INDIVIDUAL OPTIONS

INTERIOR EQUIPMENT - WATER

HOLIDAY

STYLE

Price excl.  
VAT

C57

Washer/dryer, 6 kg, 220 V (only with D3 layout)	○	○	2.750,00 €	<input type="checkbox"/>
Preparation for washing machine, 110 V (incl. grey water tank, only with D3 layout)	○	○	1.650,00 €	<input type="checkbox"/>
Electric toilet [1 x] front cabin with fresh water flush system for B1 layout	○	○	1.090,00 €	<input type="checkbox"/>
Electric toilet [2 x] front cabin with fresh water flush system for B2 layout	○	○	2.180,00 €	<input type="checkbox"/>
Electric toilet [2x] aft cabin with fresh water flush system for D1 or D3 layout	○	○	2.180,00 €	<input type="checkbox"/>
Electric toilet [1 x] aft cabin with fresh water flush system for D2 Layout	○	○	1.090,00 €	<input type="checkbox"/>
Grey water system, totalling 244 L	○	○	3.600,00 €	<input type="checkbox"/>
<b>INTERIOR EQUIPMENT - GALLEY</b>				
Microwave, 220 V	○	○	710,00 €	<input type="checkbox"/>
Dishwasher, drawer 220 V	○	○	3.250,00 €	<input type="checkbox"/>
Drawer fridge incl. Freezer unit totalling 160 L (replacing standard fridge)	○	○	2.990,00 €	<input type="checkbox"/>
Wine cooler, 220 V (only with Inverter)	—	○	2.950,00 €	<input type="checkbox"/>
Fridge in galley	○	○	1.450,00 €	<input type="checkbox"/>
Icemaker (only with D3 layout)	—	○	2.650,00 €	<input type="checkbox"/>
Dedicated space for coffee machine incl. 220 V socket	○	○	230,00 €	<input type="checkbox"/>
<b>INTERIOR EQUIPMENT - FRESH AIR</b>				
Air conditioning 22.000 BTU, cabins (no outlet for bunkbed D2) incl. 2nd shore power (220 V / 110 V, only with generator) (not in combination with hot air heating)	○	○	12.750,00 €	<input type="checkbox"/>
Air conditioning 2 x 8.000 BTU, salon (incl. outlet for bunkbed D2) incl. 2nd shore power (220 V / 110 V, only with generator) (not in combination with hot air heating)	○	○	9.400,00 €	<input type="checkbox"/>
<b>INTERIOR EQUIPMENT - HEATING</b>				
Hot air heating, 2 x 4 kW, outlets in salon and cabins, fueling via diesel tank (not in combination with air conditioning)	○	○	7.950,00 €	<input type="checkbox"/>
<b>ELECTRICAL SYSTEMS 230 V</b>				
Additional 2 x service batteries, 12 V / 2 x 95 Ah, AGM	○	○	950,00 €	<input type="checkbox"/> HP, SP
230 V Inverter 2500 W (true sine wave)	○	○	3.100,00 €	<input type="checkbox"/>
110 V Inverter 2000 W (true sine wave)	○	○	3.100,00 €	<input type="checkbox"/>
Generator 6.4 kW / 8 kVA, 50 Hz, 230 V	○	○	17.750,00 €	<input type="checkbox"/>
Generator 8 kW / 50 Hz, 230 V (recommended for Air conditioning 22.000 BTU)	○	○	19.800,00 €	<input type="checkbox"/>
Generator 6.4 kW / 8 kVA, 60 Hz, 110 V	○	○	22.950,00 €	<input type="checkbox"/>
Generator 8 kW, 2 x 110 V / 60Hz (recommended for Air conditioning 2 x 8.000 BTU)	○	○	24.450,00 €	<input type="checkbox"/>
Country version US/JPN	○	○	3.450,00 €	<input type="checkbox"/>
<b>MISCELLANEOUS</b>				
Composite gangway incl. bag and stanchions, foldable, 230 cm	○	○	2.300,00 €	<input type="checkbox"/>
Fresh water dockside inlet	○	○	510,00 €	<input type="checkbox"/>
Cockpit tables cover [according to BAVARIA Style Guide]	—	○	950,00 €	<input type="checkbox"/>
Steering wheels covers [according to BAVARIA Style Guide]	—	○	1.080,00 €	<input type="checkbox"/>
<b>SHIPMENT</b>				
Steel cradle for overseas transport	○	○	7.500,00 €	<input type="checkbox"/>
Steel cradle for overseas transport without keel	○	○	9.400,00 €	<input type="checkbox"/>
Shrink wrap	○	○	1.250,00 €	<input type="checkbox"/>

— Not available    ■ Standard    ○ Optional



Bavaria Yachtbau GmbH, Bavariastraße 1, D-97232 Giebelstadt, Phone +49 9334 942-0, Fax +49 9334 942-1160, [www.bavariayachts.com](http://www.bavariayachts.com), [info@bavariayachts.com](mailto:info@bavariayachts.com)

All prices are in EURO and are valid only in conjunction and at the time of ordering a new yacht ex works Giebelstadt. All measurements and weights are calculations based upon design documents. The brochure is intended for advertisement only and is not part of a contract, warranty or of any offer. We reserve the right to modify or improve our products and to change specifications without notice. We are not liable for errors and printing mistakes. Aforementioned prices are recommended sales prices for deliveries ex works within 4 months of order placement. Later deliveries are subject to invoicing according to the then valid price list.

Version: 2/2021

Valid from 1<sup>st</sup> April 2021

Publication: 1<sup>st</sup> April 2021 – The previous price list loses its validity.

Language/Taxes: English pricelist/all prices excl. VAT

