

Concept R

AUTO REFILL SET

CP-RC-AF

INSTRUCTIONS FOR INSTALLATION AND USE
English

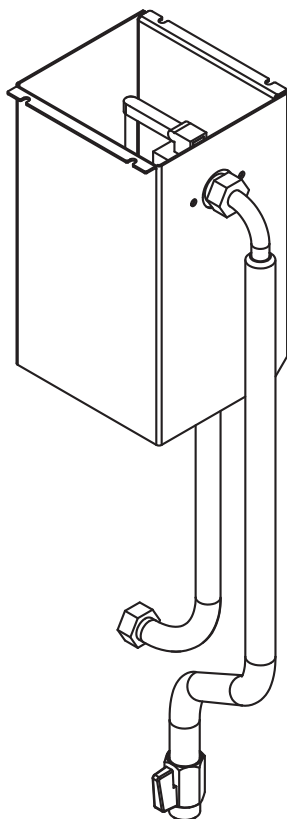

EN

Table of Contents

1. About this instruction manual	3
2. Important information for your safety	4
2.1. Intended use	4
2.2. Safety information for the installer	4
3. Product description	5
3.1. Scope of delivery	5
3.2. Product functions	5
4. Installation and connection to sauna heater	
Concept R combi	6
4.1. Preparing the sauna heater	6
4.2. Installing the auto-refill unit	7
5. Installation and connection to auxiliary evaporator	
Concept R	8
5.1. Preparation of the auxiliary evaporator	8
5.2. Installing the auto-refill unit	9
6. Connecting the water inlet pipe	10
7. Function test	10
8. Troubleshooting	10
9. Cleaning and maintenance	11
10. Disposal	11
11. Technical data	12

1. About this instruction manual

Carefully read these instructions for installation and use, and keep them near the sauna. This ensures that you can refer to information regarding the function and installation at any time.



These installation and operating instructions can also be found in the downloads section of our website: www.sentiotec.com.

Symbols used for warnings

These installation and operating instructions feature warning symbols next to activities presenting a hazard to the user. Warning symbols must be observed at all times. This prevents damage to property and injuries, which in the worst case may be fatal.

The warning symbols contain keywords with the following meanings:



DANGER!

Serious or fatal injury will occur if this warning symbol is not observed.



WARNING!

Serious or fatal injury may occur if this warning symbol is not observed.



CAUTION!

Minor injuries may occur if this warning symbol is not observed.

ATTENTION!

This keyword is a warning that damage to property may occur.

Other symbols



This symbol indicates tips and useful information.

2. Important information for your safety

The CP-RC-AF auto-refill set has been manufactured in accordance with the applicable safety regulations for technical units. However, hazards may occur during use. You should therefore adhere to the following safety information and the specific warnings in the individual chapters.

2.1. Intended use

The CP-RC-AF auto-refill set enables the evaporator tank in the Concept R combi sauna heater or the Concept R auxiliary evaporator to be automatically refilled. The CP-RC-AF auto-refill set is suitable for the following models:

- CP-RC-090
- CP-RC-105
- CP-25-STP

Any use exceeding this scope is considered improper. Improper use can result in damage to the product, severe injuries or death.

2.2. Safety information for the installer

- The fixed water connection should be installed only by a qualified installer or a comparably qualified person according to the local provisions of the responsible water company.
- The provisions of **EN 61770** and **EN 1717** must be observed. Appropriate measures must be taken to ensure that water cannot flow back into the drinking water system.
- A shut-off valve must be fitted between the fixed network and the auto-refill set. In case of extended periods of non-use of the fixed water connection, the shut-off valve should be closed.

- Observe the minimum and maximum supply water pressure specified in the technical data (see **11. Technical data on page 12**).
- A drain must be located at the bottom of the sauna room in case the water line is damaged or begins to leak.
- For the connection, only use the hose set included or one obtained from customer service. Under no circumstances should you use existing or previously used hose sets.
- For your own safety, consult your supplier in the event of problems that are not explained in sufficient detail in the installation instructions.

3. Product description

3.1. Scope of delivery

- Auto-refill unit with water connection pipes
- Mounting screws
- Sealing ring
- Instructions for installation and use

3.2. Product functions

The auto-refill set works based on the principle of filling level measurement. If the level of the water in the evaporator tank drops, the float loses buoyancy and therefore opens the water valve on the auto-refill unit. This valve ensures that fresh water flows into the evaporator tank until the float rises and makes the water valve close again.

4. Installation and connection to sauna heater

Concept R combi

Please take the following points into account when installing and connecting the auto-refill unit:



WARNING!
Risk of electric shock

- The sauna heater may only be installed and connected when the power supply is disconnected.

- Work should only be performed on the sauna heater once it has cooled down.

4.1. Preparing the sauna heater

- Make sure that the sauna heater has completely cooled down and remove the ceramic bowl for herbs and aromas **1**.
- Remove the steam funnel **2** located under the evaporator tank.
- Remove the strut **3** with a suitable screwdriver.

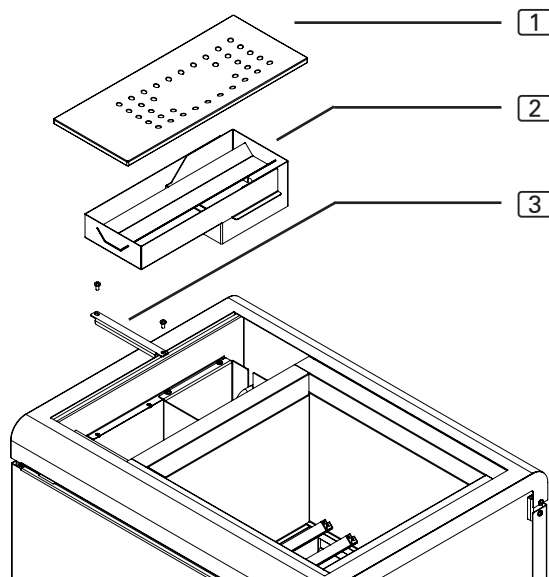

4.2. Installing the auto-refill unit

1. Feed the water inlet pipe [3] through the installation opening next to the evaporator until the ball valve is visible at the bottom.
2. Remove the sealing cap of the evaporator tank connection [6].
3. Place the flat seal [4] into the union nut on the evaporator tank inlet pipe [5].
4. Connect the evaporator tank inlet pipe [5] to the evaporator tank connection [6].
5. Place the auto-refill unit [7] into the installation position intended.
6. Screw on the auto-refill unit in four places using the screws provided.

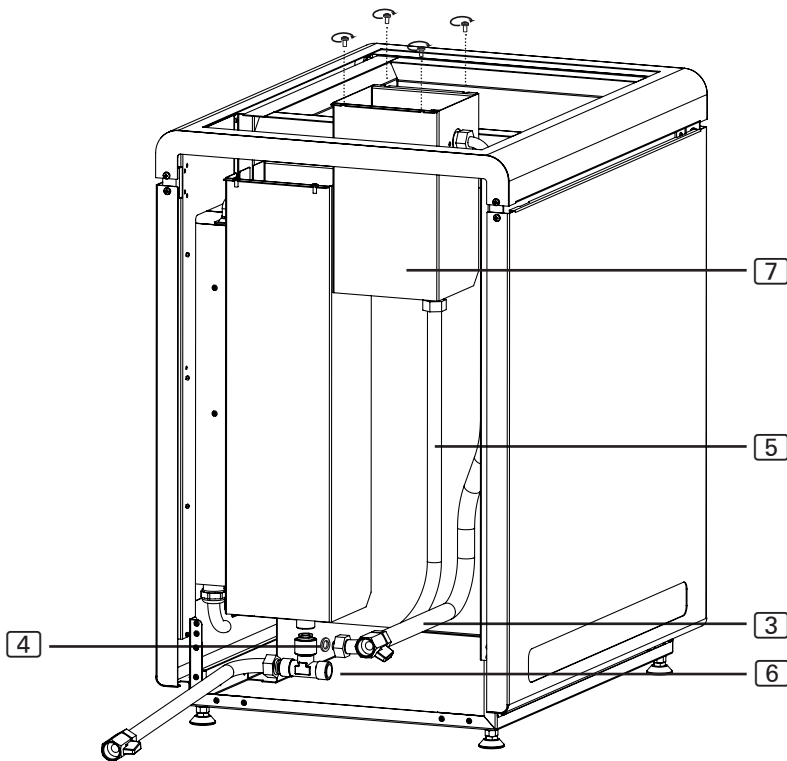

5. Installation and connection to auxiliary evaporator

Concept R

Please take the following points into account when installing and connecting the auto-refill unit:



WARNING! *Risk of electric shock*

- The auxiliary evaporator may only be installed and connected when the power supply is disconnected.

- Work should only be performed on the auxiliary evaporator once it has cooled down.

5.1. Preparation of the auxiliary evaporator

- Make sure that the auxiliary evaporator has completely cooled down and remove the ceramic bowl for herbs and aromas **1**.
- Remove the steam funnel **2** located under the evaporator tank.
- Remove the strut **3** with a suitable screwdriver.

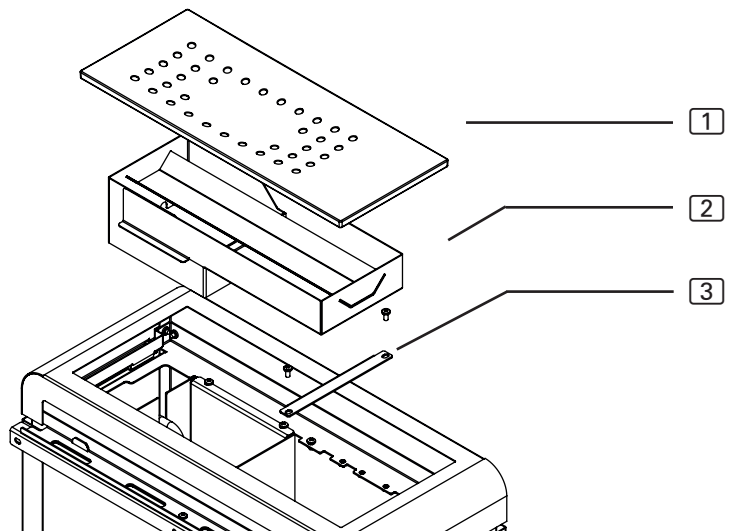

5.2. Installing the auto-refill unit

1. Feed the water inlet pipe [3] through the installation opening next to the evaporator until the ball valve is visible at the bottom.
2. Remove the sealing cap of the evaporator tank connection [6].
3. Place the flat seal [4] into the union nut on the evaporator tank inlet pipe [5].
4. Connect the evaporator tank inlet pipe [5] to the evaporator tank connection [6].
5. Place the auto-refill unit [7] into the installation position intended.
6. Screw on the auto-refill unit in four places using the screws provided.

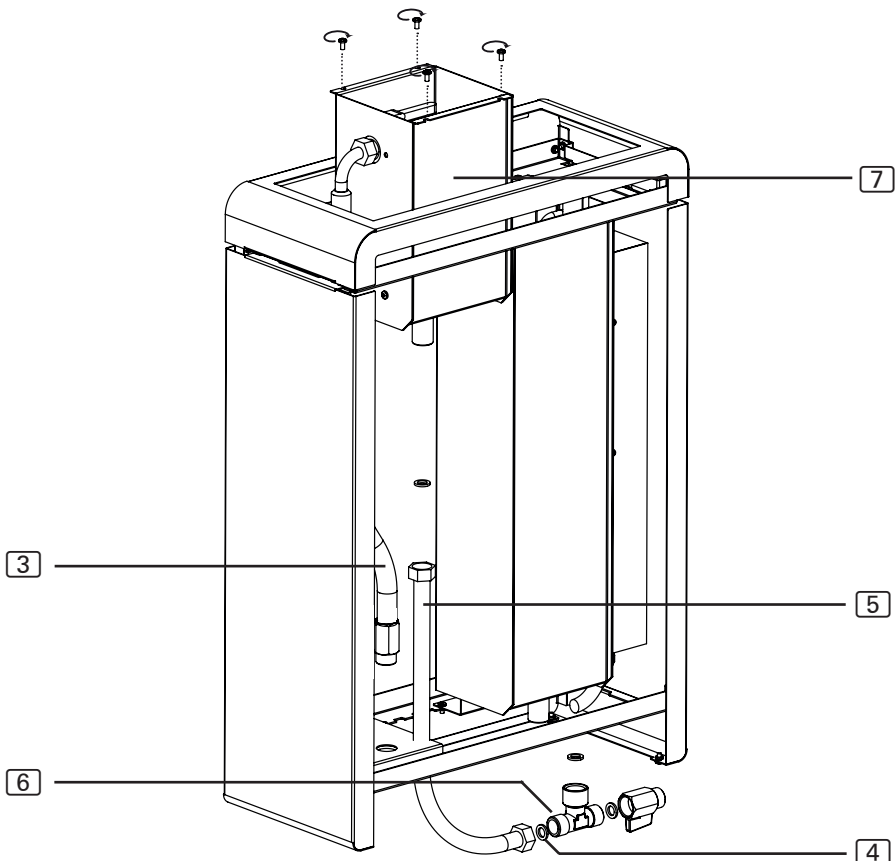

EN

6. Connecting the water inlet pipe

- Connect the on-site fixed water connection to the ball valve on the water inlet pipe **3**.
 - ▶ Observe the information regarding water pressure when doing so (see **11. Technical data on page 12**)
 - ▶ A shut-off valve must be mounted between the fixed network and the fixed water connection, and it should be closed when not in use.

7. Function test

1. Turn on the on-site water inlet pipe fully.
2. Open the ball valve of the water inlet pipe fully.
 - ▶ The evaporator tank fills up with water.
 - ▶ Once the maximum mark is reached, the evaporator tank stops filling up automatically.
3. Start the evaporator.
 - ▶ When the water level in the evaporator tank drops, the auto-refill unit fills it up with water automatically.

8. Troubleshooting

If the evaporator tank does not fill up automatically, check the water pressure of the on-site fixed water connection and that the float moves freely in the auto-refill unit.

- ▶ If the float does not move freely, check for any obstructions or dirt.
- ▶ If the problem persists, consult your customer service specialist.

9. Cleaning and maintenance

The auto-refill set is maintenance-free.

10. Disposal



- Dispose of packaging materials in accordance with the applicable disposal regulations.
- Used devices contain reusable materials, as well as hazardous substances. Do not dispose of your used device with household waste, but do so in accordance with the locally applicable regulations.

11. Technical data

General information

Capacity:	Approx. 1.5 litres
Material:	Stainless steel sheet

Water connection

Minimum water supply pressure:	30 kPa (0.3 bar)
Maximum water supply pressure:	600 kPa (6 bar)
If pressure is over 600 kPa (6 bar):	
▶ Pressure limiter (standard regulator) mounted between the fixed water connection and the auto-refill unit.	
Fixed water connection:	1/2" (1.27 cm)

Tank dimensions

Length:	135 mm
Width:	135 mm
Depth:	255 mm

Length of connection lines

Water inlet pipe:	1000 mm
Evaporator cable:	500 mm





WORLD OF WELLNESS

sentiotec GmbH world of wellness Oberregauer Straße 48 4844 Regau, Austria

T +43 (0) 7672/277 20-800 F +43 (0) 7672/277 20-801

E info@sentiotec.com www.sentiotec.com