

MODEL	SUB-CLASS	NEEDLE PLATE	FEED DOG	PRESSER FOOT	HOOK ASM	BOBBIN CASE ASM	BOBBIN	NEEDLE	HAND WHEEL	MOTOR
機 型	規 格	針 板	送 具	押 具	梭 頭	梭 殼	梭 子	針 號	手 輪	馬 達
DL7200-BM1-10 ~ DL7200-BM1-16	中厚布料 至 厚布料	E1704	D1701	P1701	G1121	G1202	G1303	DBX1#14	LH1500-E	BHL-439P0035A
DL7200-BM1A-10 ~ DL7200-BM1A-16		E1704D	D1702	P1701	G1125J	G1202	G1303	DBX1#21	LH1500-E	BHL-439P0035A
DL7200-BH1-10 ~ DL7200-BH1-16	厚布料	E1711	D1711	P1711	G1125J	G1202	G1303	DBX1#21	LH1500-E	BML-437P0035A
DL7200-BH1A-10 ~ DL7200-BH1A-16	厚布料	E1711D	D1711D	P1711D	G1125J	G1202	G1303	DBX1#21	LH1500-E	BML-437P0035A
DL7200-BX2-10 ~ DL7200-BX2-16	特厚料	E2711	D2711	P2711	G2125J	G2202	G2303	DPX5#21	LH1500-E	BML-237P0035A

PARTS LIST FOR LE GROUP

BYL-LE

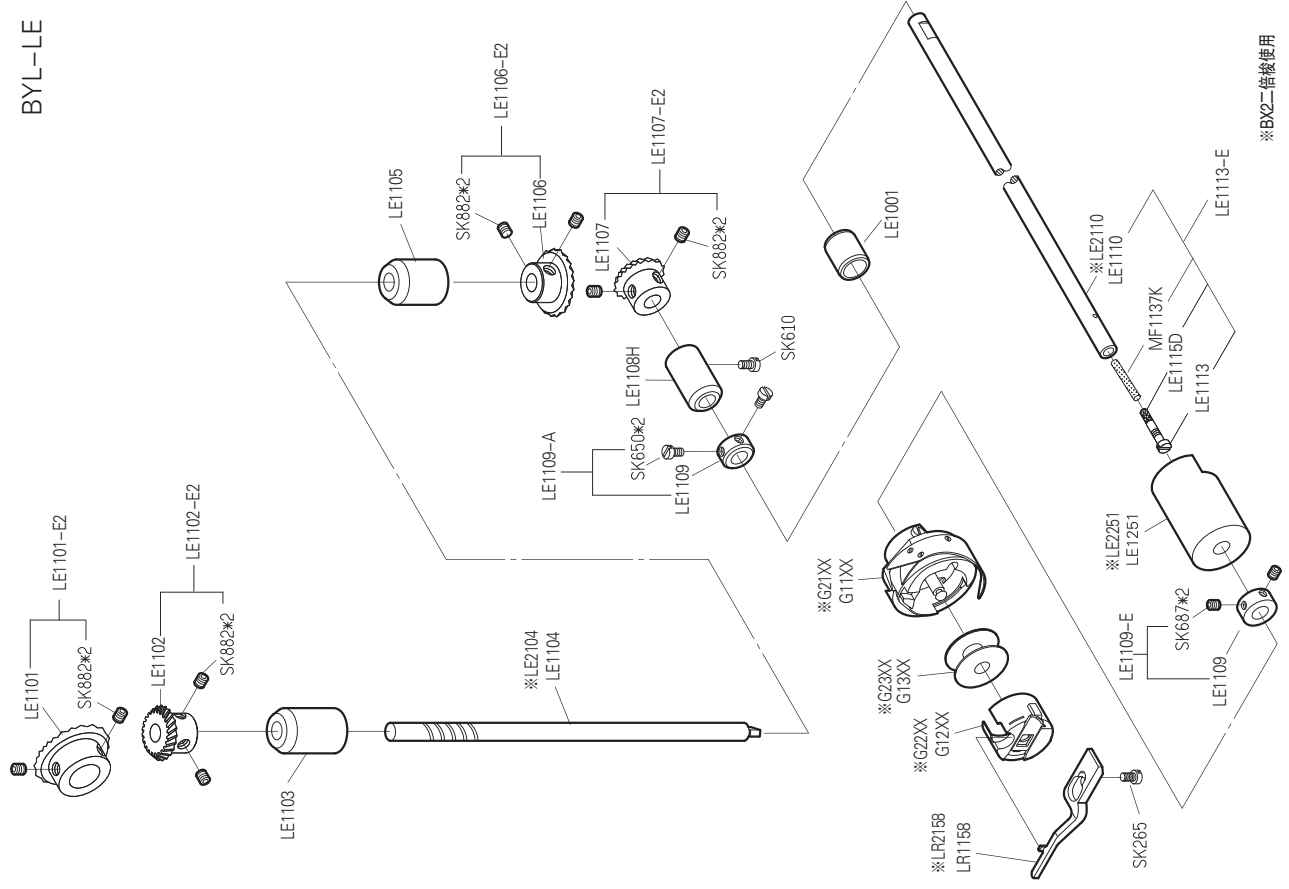

*BX2二倍使用

PARTS LIST FOR LD GROUP

BYL-LD

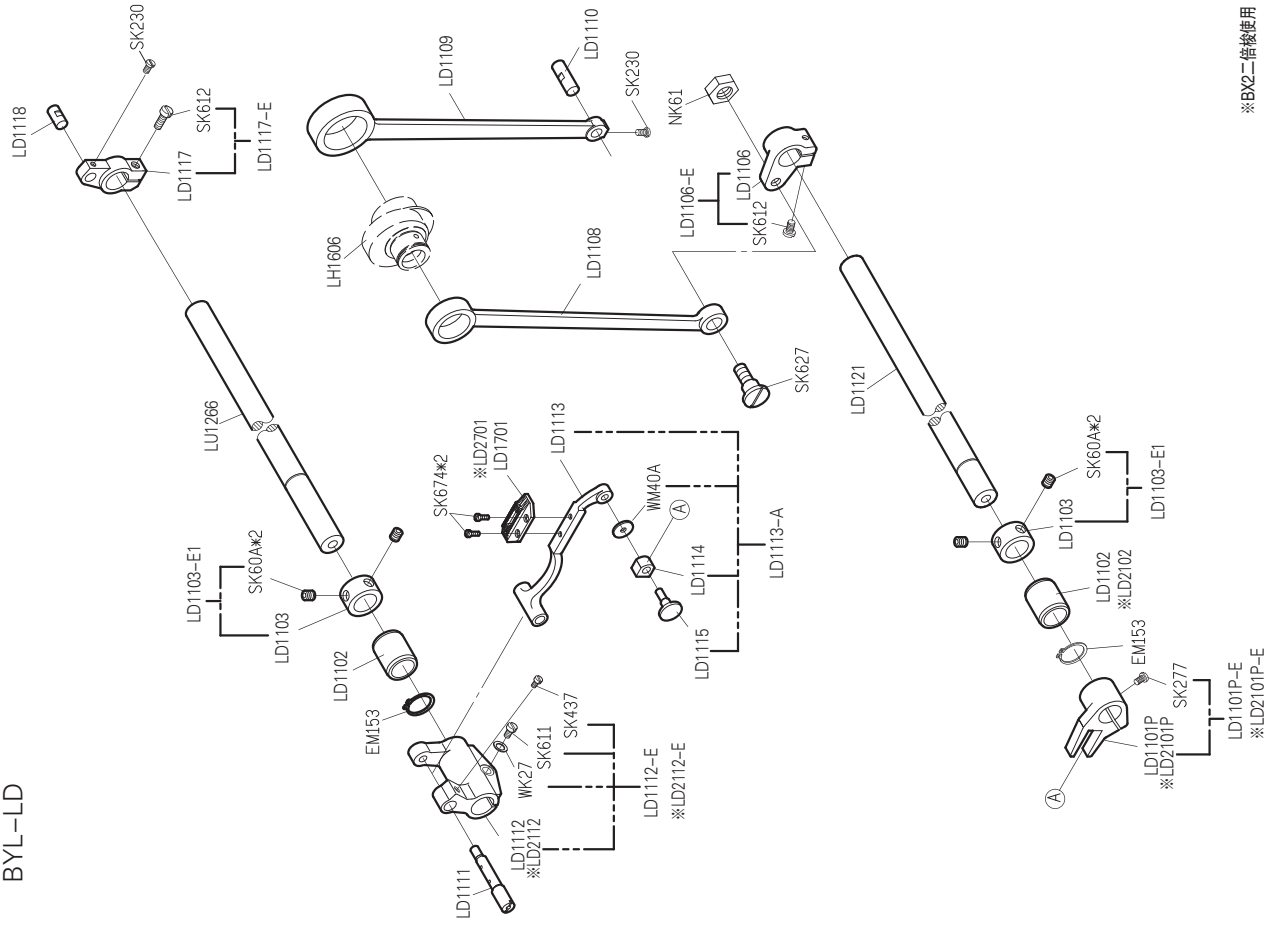

*BX2二倍使用

BYL-LG

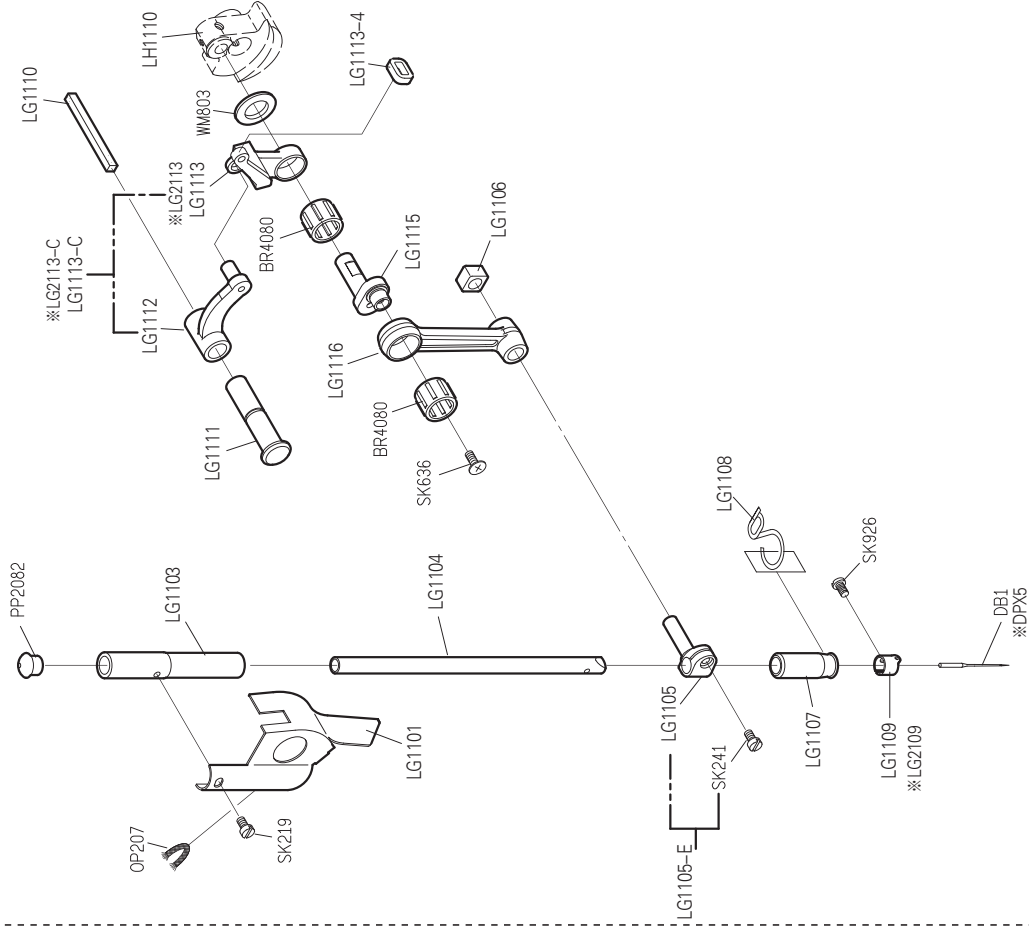

※BX2二倍検使用

PARTS LIST FOR LG GROUP

BYL-LH

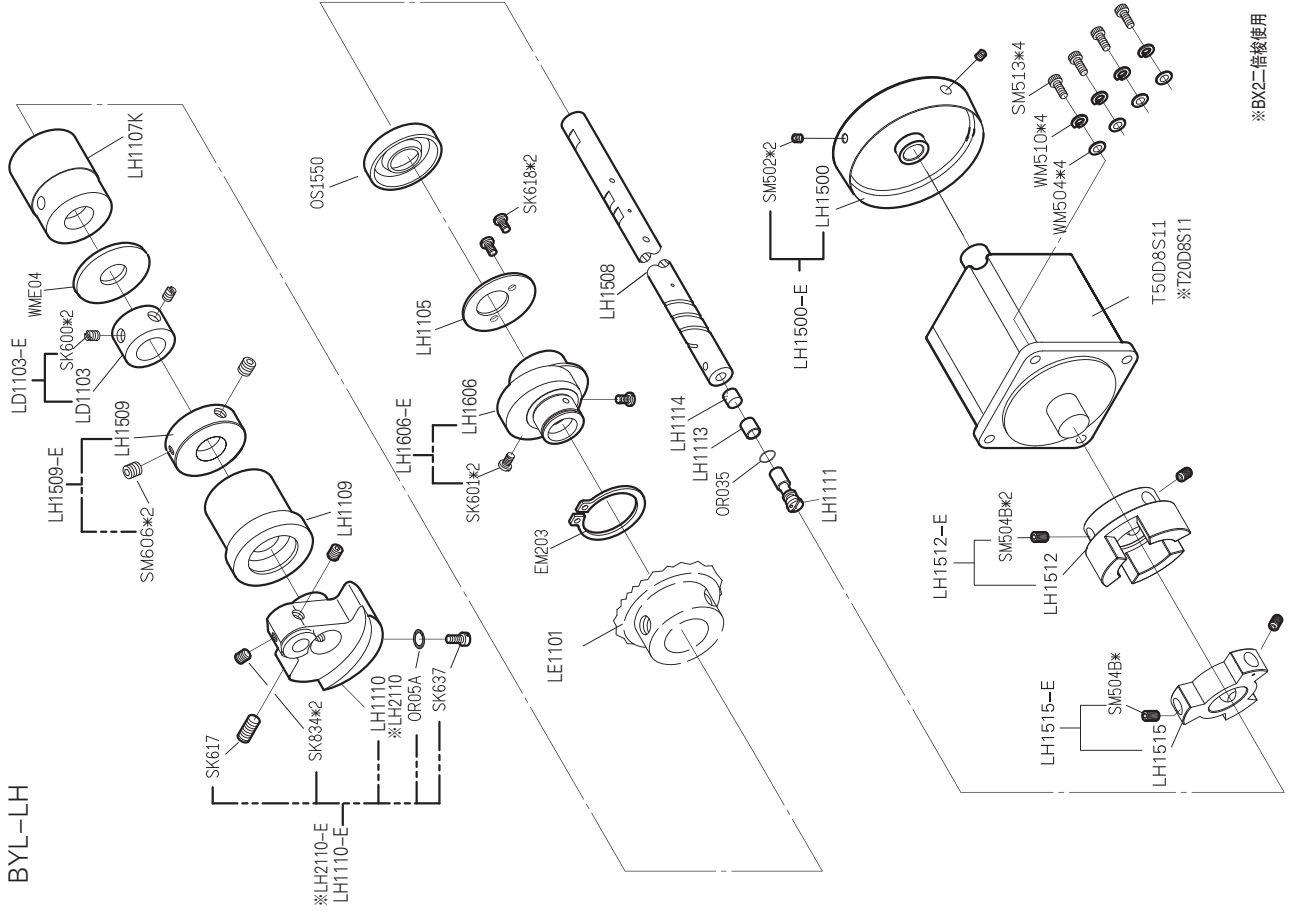

※BX2二倍検使用

PARTS LIST FOR LH GROUP

电子夹线器

ELECTRONIC CONDUCTOR HOLDER

BYL-LU

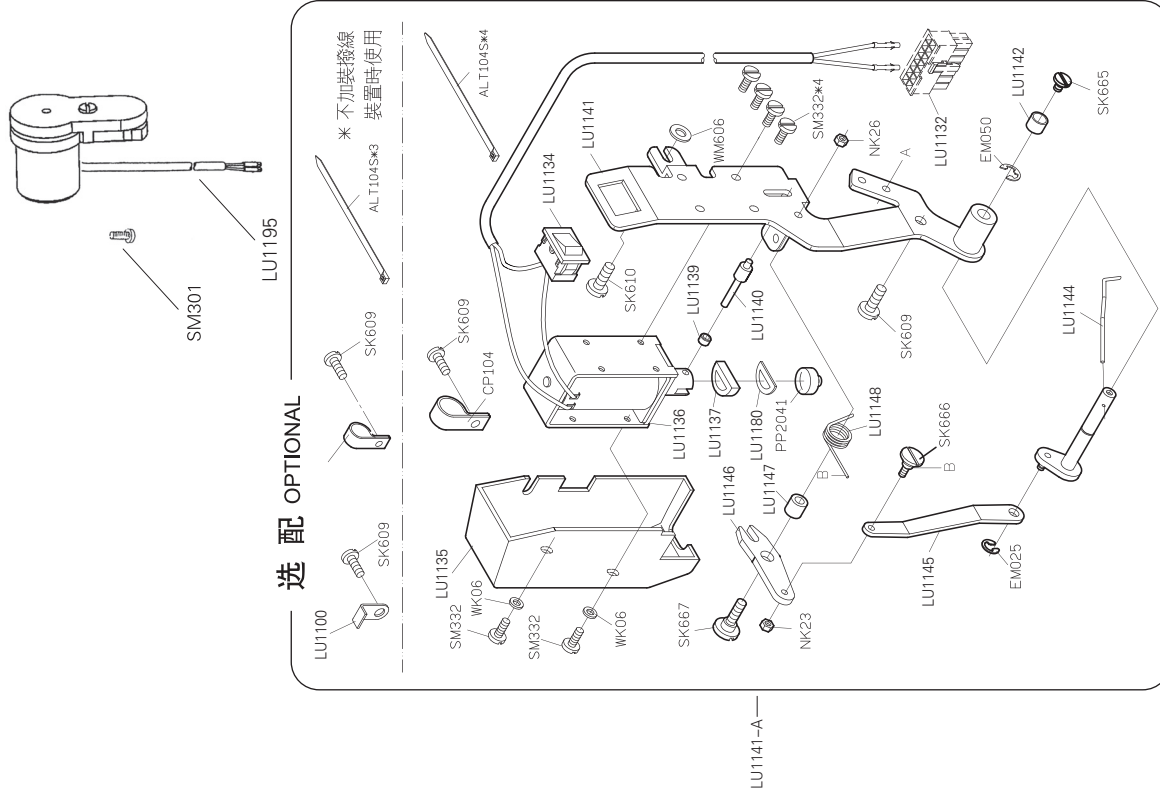

※BX2二倍檢使用

BYL-LU

LU1151-A

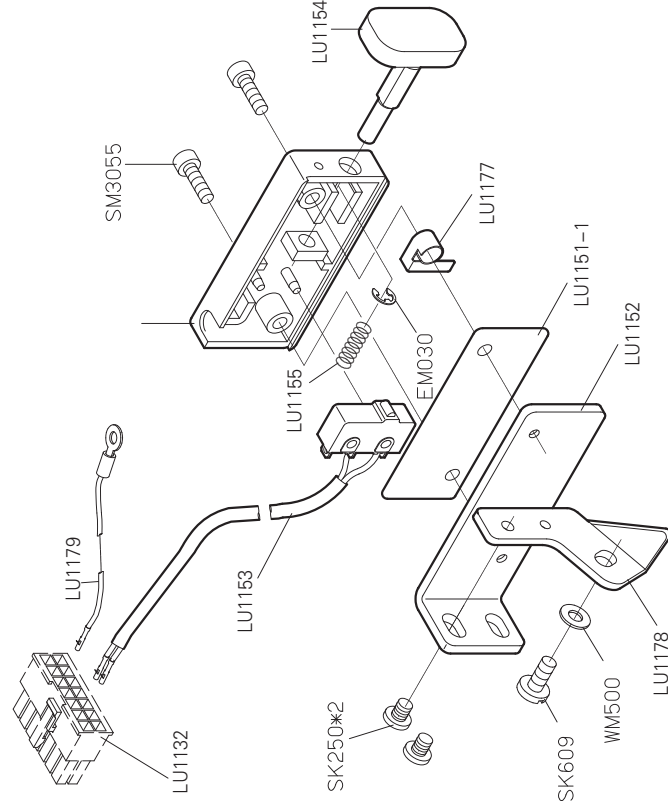

※BX2二倍檢使用

PARTS LIST FOR LU GROUP

BYL-LU

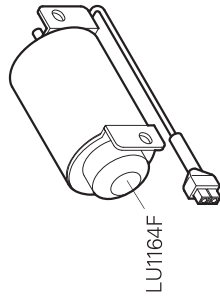
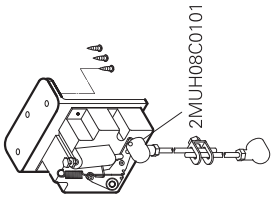

LU1164F

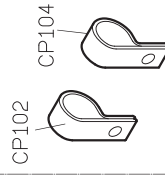

CP102

CP104

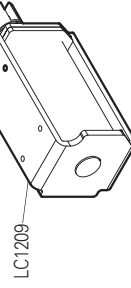

LC1209

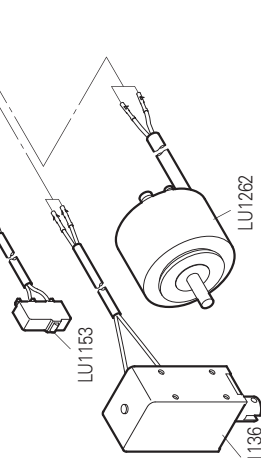

LU1153

LU1262

LU1136

※BX2二倍使用

PARTS LIST FOR LU GROUP

LU1164F-A1/LU1164D-A1

BYL-LU

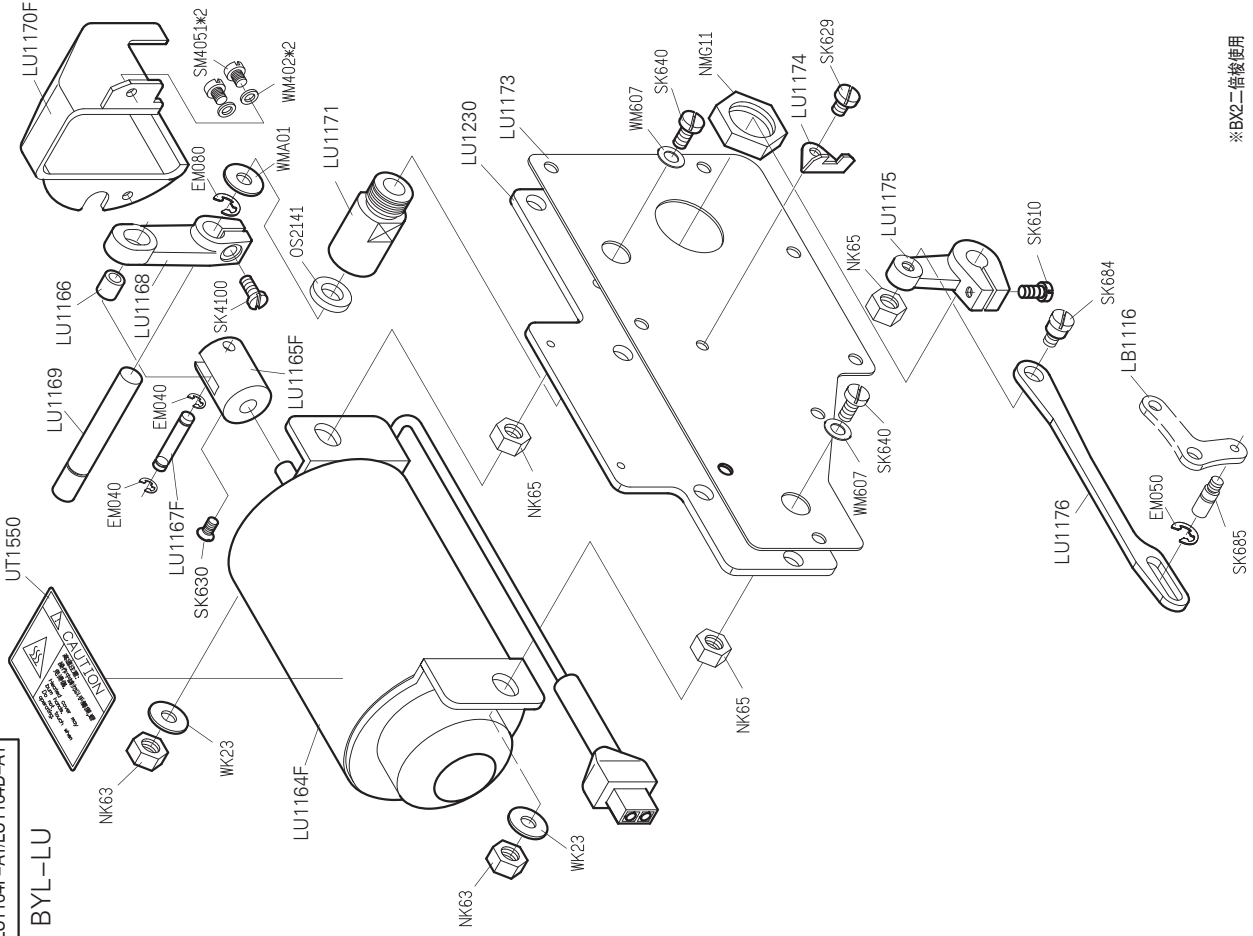

※BX2二倍使用

BYL-LW

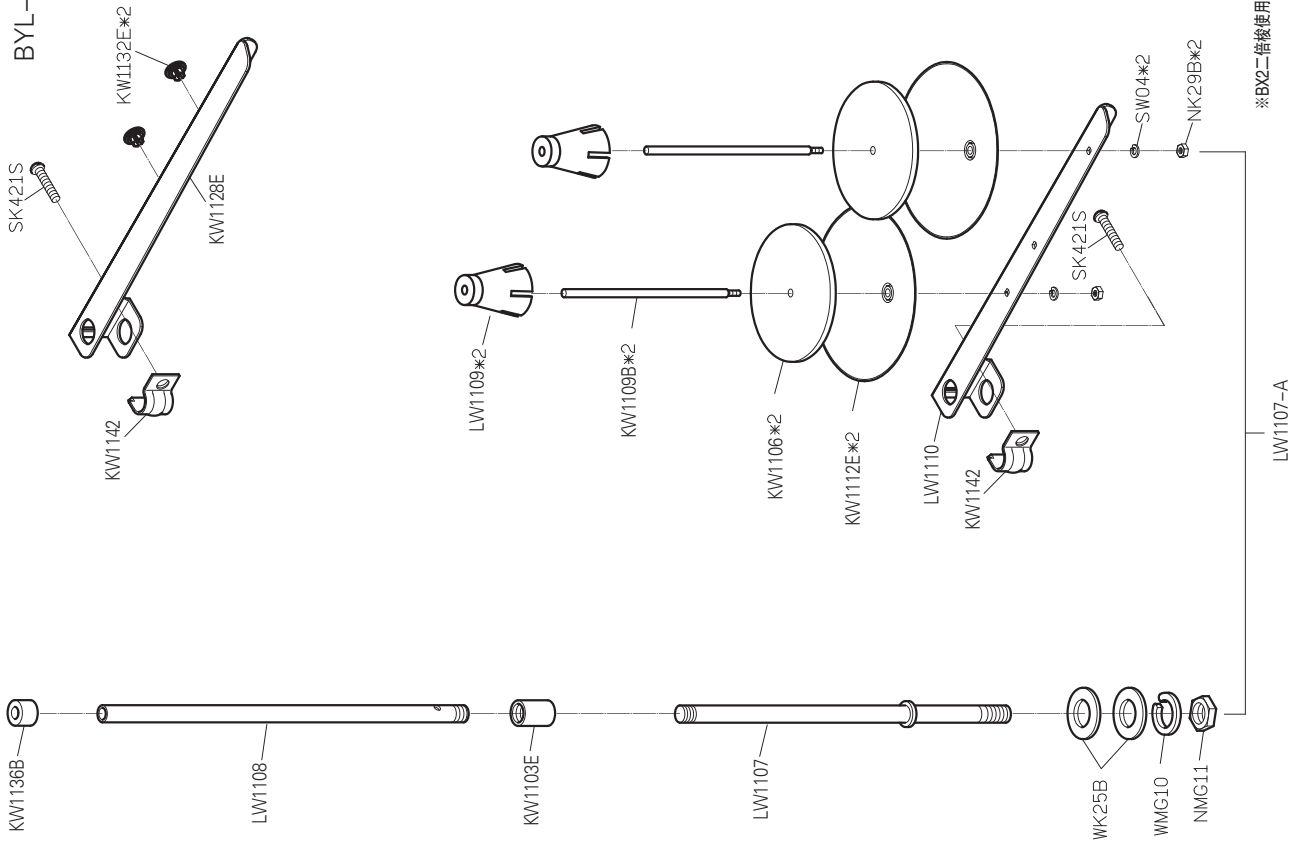

PARTS LIST FOR LW GROUP

BYL-LY

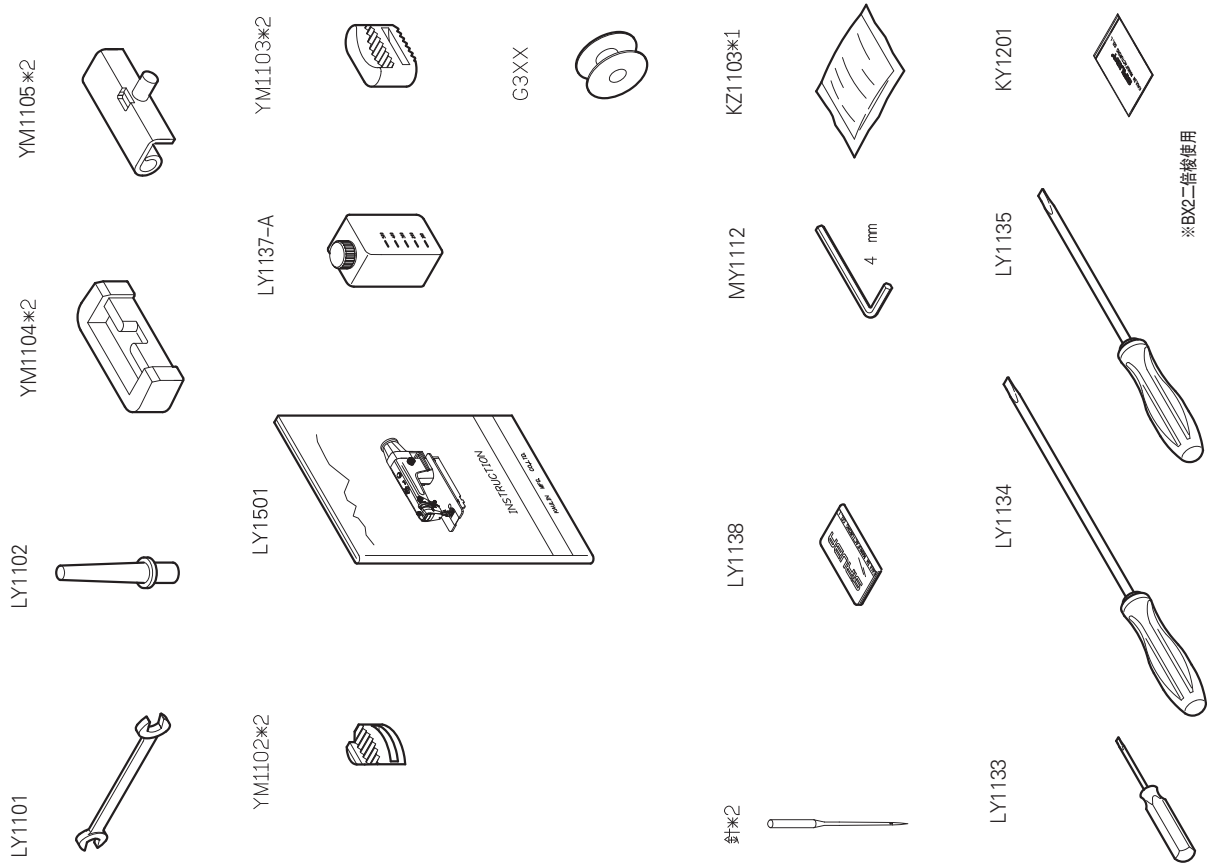

PARTS LIST FOR LY GROUP

PARTS LIST FOR LZ GROUP

BYL-LZ

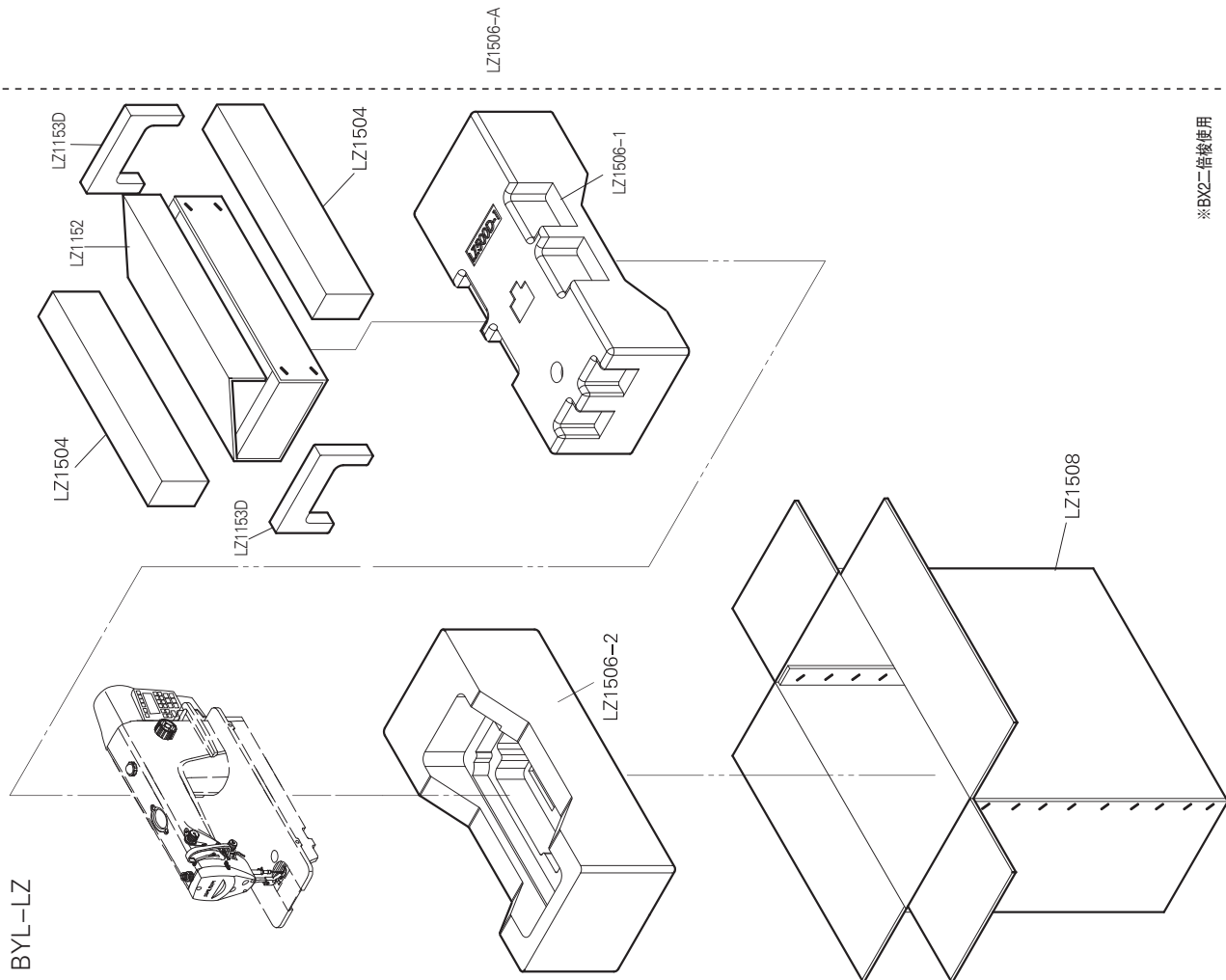

※BX2二倍使用