



# C45



## TECHNICAL DATA

C45

LOA	14,43 m	47'3"
Hull length	13,60 m	44'8"
LWL	12,87 m	42'2"
Beam max.	4,49 m	14'8"
Standard keel draft	2,20 m	7'2"
Shallow keel draft	1,75 m	5'8"
Performance keel draft	2,60 m	8'6"
Ballast	3.065/3370/2.775 kg	6.757/7.429/6.117 lbs
Displacement	11.935 kg	26.312 lbs
Engine std	41,9 kW / 57 PS	41,9 kW / 57 PS hp
Engine opt	58,8 kW / 80 PS	58,8 kW / 80 hp
Fuel tank [approx.]	250 L	66 gal
Water tank [approx.]	589 L	130 gal
Sail area	114 m <sup>2</sup>	1.127 sq ft
Mainsail std	64 m <sup>2</sup>	688 sq ft
Mainsail furling	58 m <sup>2</sup>	624 sq ft
Genoa	50,00 m <sup>2</sup>	538 sq ft
Gennaker	180 m <sup>2</sup>	1.937 sq ft
Code 0	90 m <sup>2</sup>	968, sq ft
Mast height above WL	21,57 m	70'9" ft
I	18,40 m	60'4" ft
J	5,25 m	17'4" ft
P	17,70 m	58'1" ft
E	6,03 m	19'10" ft
CE category	A	A
Design	Cossutti Yacht Design	Cossutti Yacht Design

TRIM LEVEL	BASE PRICE EX WORKS EXCL. VAT
HOLIDAY	225.000,00 €
STYLE	234.200,00 €

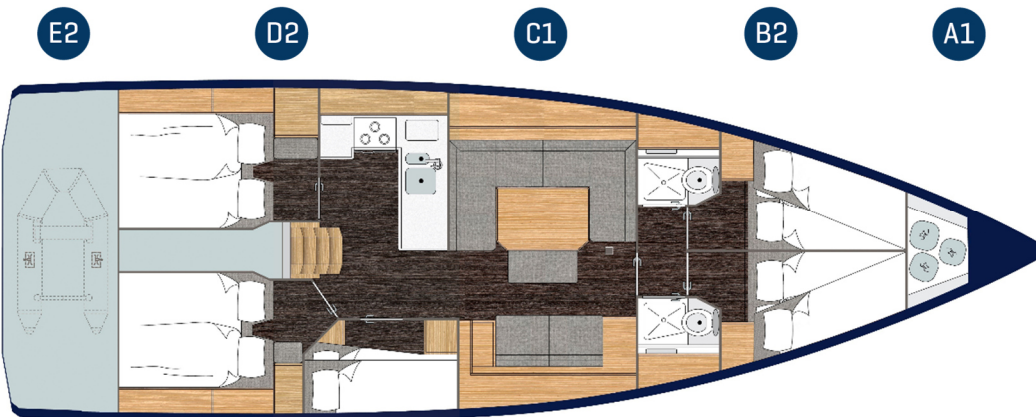
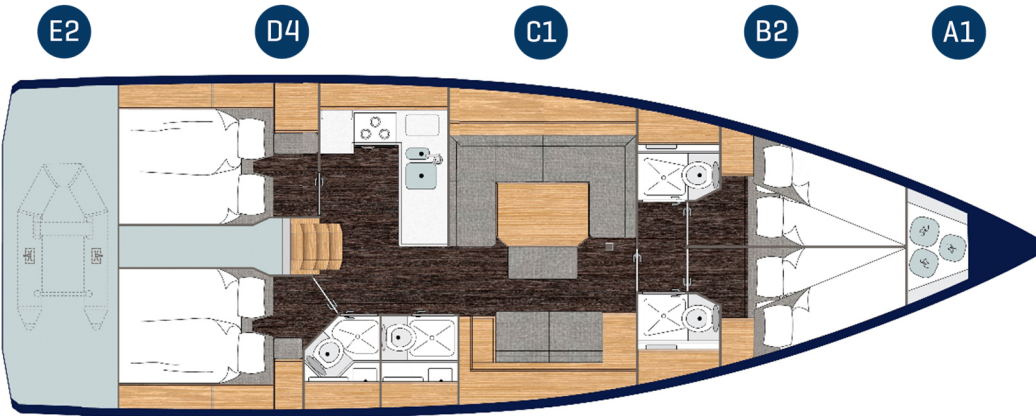
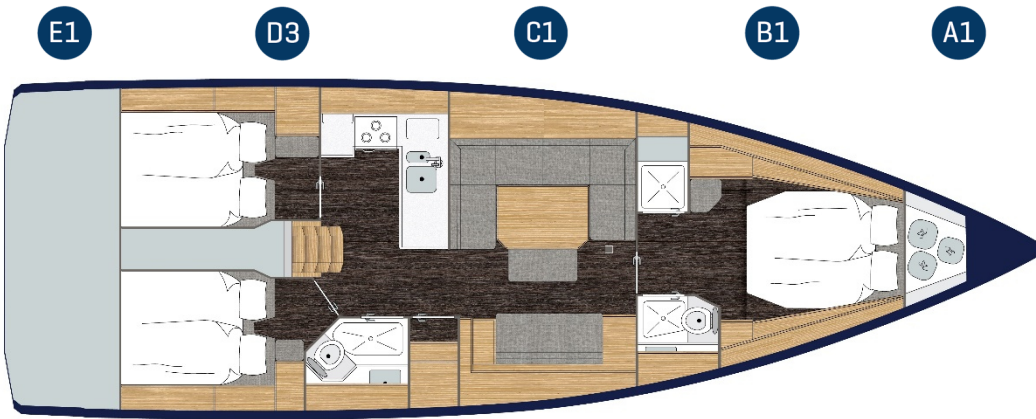
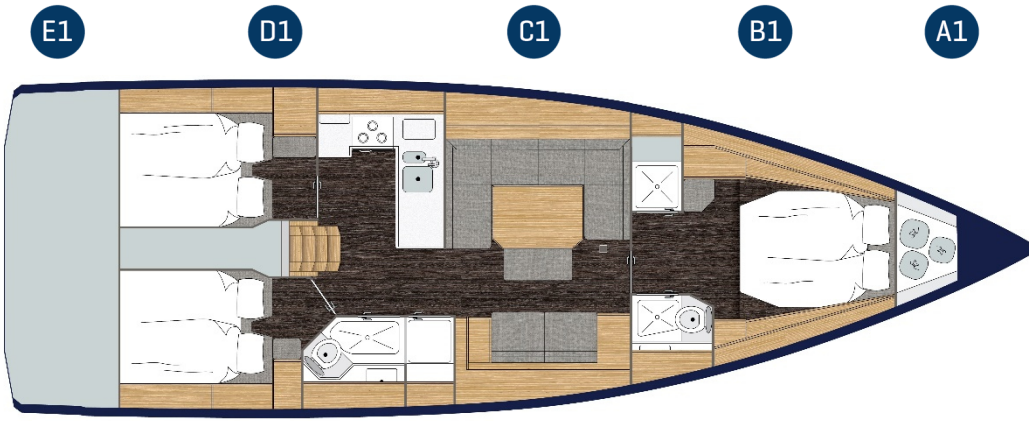

**Hull**

Hull in sandwich construction

**Keel**

L-shaped keel, cast iron, draft 2,20 m

**Steering System**Twin wheel steering system  
Single rudder**Propulsion**Diesel engine, 42 kW / 57 hp, sail drive  
Mechanical throttle, mounted on steering pedestal, starboard  
3 blade fixed propeller**Interior Layout**A1: Sail locker  
B1: Queen size "island" double berth, storage, separate head and shower stall  
C1: Salon incl. L shaped galley, dining area on port, lounge area and chart table on stb  
D3: 2 twin cabins aft incl. head and utility room on stb  
E1: Storage space for toys and equipment under cockpit, access via cockpit floor hatch**Interior Styling**"Classic" Mahogany interior  
"Elm" floor  
Laminate worktop surface in galley "brown stone"**Upholstery**Upholstery "Vela" in salon  
Standard mattresses for all berths**Interior Equipment**Fridge in galley, 110L, top loading  
3 burner stove with oven  
Salon dining table**Plumbing System**40 L boiler  
70 L holding tank, per toilet  
Electric and manual bilge pump**Electrical Systems**1 x engine battery, 12 V / 95 Ah, AGM  
2 x service batteries, 12 V / 2 x 95 Ah, AGM  
Battery charger, 40 Ah [3 channels]  
230 V socket in each cabin  
Country version EU**Cockpit & Deck**Deck in sandwich construction, cockpit floor, side decks and coach roof with non-slip structure  
Bathing platform, electric  
Teak on cockpit benches and bathing platform  
Companion way with washboard and sliding hatch in acrylic glass, lockable  
Flush hatches  
Dedicated life raft storage in cockpit floor  
Stainless steel steering wheels with leather cover**Mooring & Anchoring**Stainless steel anchor arm with roller, fixed  
4 mooring cleats, stainless steel, fixed**Standing & Running Gear**Sportmast deck stepped 2 spreader, aluminium  
Above deck jib furling system  
Rod kicker  
Backstay adjuster, mechanical  
Midboom sheeting system  
Elvström Cruisetech Dacron mainsail & self-tacking jib  
  
2 x halyard winches, size 50, manual

TRIM LEVEL EQUIPMENT	HOLIDAY	STYLE	C45
<b>Hull</b>			
Hull colour signal white with dark blue cove- and waterline	■		
Hull colour signal white with silk grey cove- and waterline		■	
<b>Interior Styling</b>			
Upholstered headboard in front cabin [B1]		■	
Upholstered bed frames in front and aft cabins		■	
Fabric covered ceiling panels in salon		■	
Leather style covered chart table		■	
Leather style covered handrails		■	
<b>Cockpit &amp; Deck</b>			
Cockpit table, foldable	■		
Twin cockpit tables, foldable and lowerable		■	
Rope storage boxes, at helm position		■	
<b>Interior Equipment</b>			
Reading lights incl. USB charger, salon and cabins		■	
Handrail on ceiling in stainless steel with leather cover		■	

SAIL READY PACKAGES	HOLIDAY	STYLE	Price excl. VAT	C45
<b>SAIL READY PACK "HOLIDAY" [HP]</b>	○	—	11.190,00 €	□
2 Additional service batteries, 12 V / 2 x 95 Ah, AGM				
Guard rail exit, both sides				
Anchor windlass, electrical				
"Delta" Anchor, 20 kg, incl. Chain [10 mm, 50 m], galvanized				
Courtesy lights in salon				
Curtains for coachroof and hull windows				
Blinds incl. mosquito nets for hatches in salon and cabins				
2 vents on deck hatches				
LED lights in salon and cabins				
Mooring kit (6 fenders and 4 mooring lines)				
Reading lights incl. USB charger, salon and cabins				
Handrail on ceiling in stainless steel				
Rope storage boxes, at helm position				
Stainless steel bow protection				
Cockpit shower with cold and warm water				
<b>UPGRADES SAIL READY PACK "HOLIDAY" [HP]</b>				
Tunnel bow thruster incl. 2 x 95 Ah battery	○	—	6.900,00 €	□

SAIL READY PACKAGES	HOLIDAY	STYLE	Price excl. VAT	C45
<b>SAIL READY PACK "STYLE" [SP]</b>	—	○	20.100,00 €	<input type="checkbox"/>
Tunnel bow thruster incl. 2 x 95 Ah battery				
Teak on cockpit bottom				
2 Additional service batteries, 12 V / 2 x 95 Ah, AGM				
Guard rail exit, both sides				
Anchor windlass, electrical				
"Delta" Anchor, 20 kg, incl. Chain [10 mm, 50 m], galvanized				
Courtesy lights in salon and cockpit				
Curtains for coachroof and hull windows				
Blinds incl. mosquito nets for hatches in salon and cabins				
2 vents on deck hatches				
LED lights in salon and cabins				
Mooring kit (6 fenders and 4 mooring lines)				
Ambient lights in salon and cabins, dimmable				
Extractor hood in galley				
Cockpit shower with cold and warm water				
<b>UPGRADES SAIL READY PACK "STYLE" [SP]</b>				
Bow thruster incl. 2 x 95 Ah battery, retractable (Upgrade to bow thruster tunnel)	—	○	5.800,00 €	<input type="checkbox"/>

ENTERTAINMENT PACKAGES	HOLIDAY	STYLE	Price excl. VAT	C45
<b>ENTERTAINMENT PACKAGE</b>	○	○	1.950,00 €	<input type="checkbox"/>
Fusion entertainment system with integrated DVD player incl. bluetooth streaming, Multi-Zone technology at chart table				
2 x Fusion high end speakers in salon				
2 x Fusion high end speakers in cockpit, watertight				
Fusion MS-NRX 300i remote control in cockpit				
Fusion wireless link				
<b>UPGRADES ENTERTAINMENT PACKAGE</b>				
Fusion MS-RA 205 unit incl. 2x Fusion high end speakers in owner's cabin (B1 only)	—	○	950,00 €	<input type="checkbox"/>
TV preparation in salon incl. lifting mechanism (not with B4 layout)	○	○	1.650,00 €	<input type="checkbox"/>

NAVIGATION PACKAGES	HOLIDAY	STYLE	Price excl. VAT	C45
<b>NAVIGATION "BASIC" PACKAGE [ONLY IN COMBINATION WITH GRP COCKPIT TABLE]</b>	○	—	5.450,00 €	<input type="checkbox"/>
2 x B&G Triton <sup>2</sup> digital displays [one per helm station]				
B&G Zeus <sup>3</sup> 7" chart plotter at cockpit table				
B&G V60 VHF radio and AIS receiver at chart table incl. cabling and antenna				
<b>NAVIGATION "ADVANCED" PACKAGE</b>	○	○	13.150,00 €	<input type="checkbox"/>
2 x Instrument console [one per helm station]				
2 x B&G Triton <sup>2</sup> digital displays [one per helm station]				
2 x B&G Zeus <sup>3</sup> S 9" chart plotter [one per helm station]				
B&G V60 VHF radio and AIS receiver at chart table incl. cabling and antenna				
B&G H60 wireless remote handset				
B&G Autopilot				
B&G Autopilot control unit [at stb helm station]				
B&G WR10 wireless remote control for autopilot				
<b>NAVIGATION "PREMIUM" PACKAGE</b>	—	○	18.100,00 €	<input type="checkbox"/>
2 x Instrument console [one per helm station]				
2 x B&G H5000 graphic displays [one per helm station]				
2 x B&G Zeus <sup>3</sup> S 9" chart plotter [one per helm station]				
B&G V60 VHF radio and AIS receiver at chart table incl. cabling and antenna				
B&G H60 wireless remote handset				
B&G Autopilot				
2 x B&G H5000 Autopilot control unit [one per helm station]				
B&G H5000 Hydra computer				
NMEA engine information interface for chart plotter				
B&G WR10 wireless remote control for autopilot				
GoFree wireless link				
<b>UPGRADES ELECTRONIC NAVIGATION PACKAGES</b>				
B&G 4G radar	○	○	3.250,00 €	<input type="checkbox"/>
B&G ForwardScan	—	○	1.550,00 €	<input type="checkbox"/>
NAIS-500 Transponder: B&G AIS Class B Transponder	○	○	1.350,00 €	<input type="checkbox"/>
NMEA engine information interface for chart plotter [included in Navigation "Premium" Package]	○	○	950,00 €	<input type="checkbox"/>

INDIVIDUAL OPTIONS	HOLIDAY	STYLE	Price excl. VAT	C45
<b>Hull/Keel</b>				
Hull colour silk grey with white cove- and waterline	○	○	3.990,00 €	<input type="checkbox"/>
Hull colour signal white with dark blue cove- and waterline	■	○	990,00 €	<input type="checkbox"/>
Hull colour signal white with silk grey cove- and waterline	○	■	990,00 €	<input type="checkbox"/>
Hull colour signal white with jet black cove- and waterline	○	○	990,00 €	<input type="checkbox"/>
L-shaped keel, cast iron, shallow draft 1,75 m	○	○	2.650,00 €	<input type="checkbox"/>
Performance keel, cast iron/lead, draft 2,60 m	○	○	14.500,00 €	<input type="checkbox"/>
<b>Steering System</b>				
Performance rudder	○	○	3.650,00 €	<input type="checkbox"/>
<b>Propulsion</b>				
Diesel engine, 59 kW / 80 hp, sail drive	○	○	4.900,00 €	<input type="checkbox"/>
3 blade folding propeller	○	○	1.900,00 €	<input type="checkbox"/>
Stern thruster incl. 2 x 95 Ah battery, retractable (only with bow thruster retractable)	—	○	12.700,00 €	<input type="checkbox"/>
<b>Interior Layout</b>				
B2: 2 double bunk bed cabins with flex bulkhead, incl. storage and 2 heads	○	○	5.500,00 €	<input type="checkbox"/>
D1: 2 twin cabins aft incl. head with separate shower stall on stb	○	○	1.850,00 €	<input type="checkbox"/>
D2: 2 twin cabins aft, incl. bunk bed cabin on stb (only with B2 layout)	○	○	2.150,00 €	<input type="checkbox"/>
D4: 2 twin cabins aft incl. 2 heads on stb	○	○	3.700,00 €	<input type="checkbox"/>
E2: Dinghy garage with integrated transom bench and storage/wetbar [for wetbar choose option BBQ/watertap]	○	○	3.250,00 €	<input type="checkbox"/>
Dining table, lowerable, convertible into double berth incl. cushion, electrical	○	○	2.200,00 €	<input type="checkbox"/>
<b>Interior Styling [according to BAVARIA Style Guide]</b>				
Interior wood colour Mahogany "Classic"	■	■	Standard	<input type="checkbox"/>
Interior wood colour White Oak "Club"	○	○	4.500,00 €	<input type="checkbox"/>
Interior wood colour Walnut "Elegant"	○	○	4.900,00 €	<input type="checkbox"/>
Floor "Elm"	■	■	Standard	<input type="checkbox"/>
Floor "Wenge"	○	○	410,00 €	<input type="checkbox"/>
Floor "Ocean Line"	○	○	750,00 €	<input type="checkbox"/>
Laminate worktop surface in galley "Pure White stone"	○	—	290,00 €	<input type="checkbox"/>
Solid worktop surface in galley "Gravel"	—	○	1.790,00 €	<input type="checkbox"/>
Solid worktop surface in galley "Crispy Milk"	—	○	1.990,00 €	<input type="checkbox"/>
<b>Upholstery [according to BAVARIA Style Guide]</b>				
Upholstery "Nautilus" in salon	—	○	990,00 €	<input type="checkbox"/>
Upholstery "Opus" in salon, artificial leather	○	○	1.150,00 €	<input type="checkbox"/>
Upholstery "Savoy" in salon, leather	—	○	4.950,00 €	<input type="checkbox"/>
Luxury cold foam mattress with memory top incl. box springs for all berths	○	○	3.150,00 €	<input type="checkbox"/>
<b>Cockpit Upholstery [according to BAVARIA Style Guide]</b>				
Cockpit cushions incl. backrests and 6 scatter cushions	—	○	2.910,00 €	<input type="checkbox"/>
Cockpit cushions for lowerable tables	—	○	450,00 €	<input type="checkbox"/>
Cockpit cushions	○	○	1.720,00 €	<input type="checkbox"/>
Sun bed cushions on coachroof incl. headrest and cup holders	○	○	1.510,00 €	<input type="checkbox"/>
Sun bed cushions on foredeck incl. headrest and cup holders	○	○	1.590,00 €	<input type="checkbox"/>
<b>Deck Flooring</b>				
Teak on cockpit bottom	○	○	3.900,00 €	<input type="checkbox"/> SP
Teak on side decks	○	○	13.650,00 €	<input type="checkbox"/>
Teak on coachroof	—	○	5.150,00 €	<input type="checkbox"/>
<b>Deck Flooring</b>				
Esthec on cockpit benches and bathing platform instead of teak	○	○	450,00 €	<input type="checkbox"/>
Esthec on cockpit bottom	○	○	4.550,00 €	<input type="checkbox"/>
Esthec on cockpit bottom instead of teak as an upgrade to SAIL READY PACKS "STYLE"	○	○	510,00 €	<input type="checkbox"/>
Esthec on side decks	○	○	13.950,00 €	<input type="checkbox"/>
Esthec on coachroof	—	○	5.350,00 €	<input type="checkbox"/>
<b>Cockpit &amp; Deck</b>				
GRP steering wheels, black or white	○	○	1.650,00 €	<input type="checkbox"/>
Cockpit table, removable	—	—	on request	<input type="checkbox"/>
GRP cockpit table with storage, foldable	○	○	2.150,00 €	<input type="checkbox"/>
Drawer fridge incl. compressor at wet bar, 20 L (only in combination with E2 and BBQ/sink)	○	○	1.250,00 €	<input type="checkbox"/>
BBQ (gas) and sink/water tab in wet bar (only in combination with E2)	○	○	2.300,00 €	<input type="checkbox"/>
Guard rail exit, both sides	○	○	1.150,00 €	<input type="checkbox"/> HP, SP
<b>Hoods [according to BAVARIA Style guide]</b>				
Bimini top	○	○	3.950,00 €	<input type="checkbox"/>
Sprayhood with handhold	○	○	2.390,00 €	<input type="checkbox"/>
<b>Bathing platform &amp; Dinghy</b>				
Wireless remote control for bathing platform	○	○	1.390,00 €	<input type="checkbox"/>
12 V air compressor at transom for dinghy or toys (only with E2 Layout)	○	○	810,00 €	<input type="checkbox"/>
Davits, telescopic	○	○	3.690,00 €	<input type="checkbox"/>
<b>Mooring &amp; Anchoring</b>				
6 mooring cleats, aluminium, retractable	—	○	2.150,00 €	<input type="checkbox"/>
2 mooring cleats midship, stainless steel, fixed	○	○	250,00 €	<input type="checkbox"/>
Stainless steel bow protection	○	○	460,00 €	<input type="checkbox"/> HP
"Delta" Anchor, 20kg, incl. Chain (10 mm, 50 m) stainless steel, as an upgrade to SAIL READY PACK "HOLIDAY" and "STYLE"	○	○	3.300,00 €	<input type="checkbox"/>
Anchor windlass with capstans, electrical, as an upgrade to SAIL READY PACK "HOLIDAY" and "STYLE"	○	○	1.190,00 €	<input type="checkbox"/>
<b>Standing &amp; Running Gear</b>				
Carbon performance mast, boom and spreaders incl. rod rigging	—	○	on request	<input type="checkbox"/>
Mainsail furling system incl. upgrade to furling mainsail (not available for carbon rigs)	○	○	2.950,00 €	<input type="checkbox"/>
Mast step	○	○	650,00 €	<input type="checkbox"/>
Elvström Duratech Dacron (HD) mainsail & self-tacking jib	○	—	7.070,00 €	<input type="checkbox"/>
Elvström mainsail & self-tacking jib - Sporttech triradial laminate instead of standard	○	○	9.745,00 €	<input type="checkbox"/>
Elvström genoa 106% - Cruisetech Dacron (only with genoa tracks)	○	○	3.713,00 €	<input type="checkbox"/>
Elvström genoa 106% - Duratech (only with genoa tracks)	○	—	4.240,00 €	<input type="checkbox"/>
Elvström genoa 106% - Sporttech (only with genoa tracks)	—	○	6.227,00 €	<input type="checkbox"/>

INDIVIDUAL OPTIONS	HOLIDAY	STYLE	Price excl. VAT	C45
<b>Standing &amp; Running Gear</b>				
Genoa tracks with pin stop cars	○	○	1.400,00 €	<input type="checkbox"/>
Fully battened mainsail with MDS-system, incl. 2 reefs, offshore-quality (replacing standard mainsail)	○	○	1.025,00 €	<input type="checkbox"/>
Elvström gennaker incl. snuffer and gennaker gear (halyard, sheets, blocks, halyard clutch and pad eye)	○	○	5.938,00 €	<input type="checkbox"/>
Elvström Code 0 incl. Selden CX furler and gear (halyard, sheets, blocks, halyard clutch and pad eye for code 0 tack / only with bowsprit)	—	○	6.950,00 €	<input type="checkbox"/>
Lazy bag with lazy jacks for mainsail (according to BAVARIA Style guide)	○	○	1.550,00 €	<input type="checkbox"/>
Spreader lights, 4 pcs.	—	○	1.450,00 €	<input type="checkbox"/>
GRP bowsprit (black or white / recommended for gennaker and code 0)	—	○	2.800,00 €	<input type="checkbox"/>
<b>Winches</b>				
2 x halyard winches, size 50, electrical	○	○	5.050,00 €	<input type="checkbox"/>
2 x genoa/gennaker/code 0 winches, size 50, manual	○	○	1.300,00 €	<input type="checkbox"/>
2 x genoa/gennaker/code 0 winches, size 50, electrical	—	○	5.050,00 €	<input type="checkbox"/>
<b>Interior Equipment – Water</b>				
Washing machine, 220 V (only with D3 layout)	—	○	2.750,00 €	<input type="checkbox"/>
Electric toilet (1 x) front cabin with fresh water flush system for B1 layout	○	○	1.090,00 €	<input type="checkbox"/>
Electric toilet (2 x) front cabin with fresh water flush system for B2 layout	○	○	2.180,00 €	<input type="checkbox"/>
Electric toilet (1 x) aft cabin with fresh water flush system for D1 or D3 layout	○	○	1.090,00 €	<input type="checkbox"/>
Electric toilet (2 x) aft cabin with fresh water flush system (for D4 Layout)	○	○	2.180,00 €	<input type="checkbox"/>
Grey water system, totalling 244 L (reduces fresh water capacity to 345 L)	○	○	1.850,00 €	<input type="checkbox"/>
<b>Interior Equipment – Galley</b>				
Microwave, 220 V	○	○	675,00 €	<input type="checkbox"/>
Dishwasher, drawer 220 V	○	○	2.800,00 €	<input type="checkbox"/>
Additional drawer fridge incl. Freezer unit totalling 160 L	○	○	2.990,00 €	<input type="checkbox"/>
Extractor hood in galley	—	○	770,00 €	<input type="checkbox"/>
<b>Interior Equipment – Fresh Air</b>				
Air conditioning 16.000 BTU, cabins (no outlet for bunkbed D2) incl. 2nd shore power (220 V / 110 V, only with generator) (not in combination with hot air heating)	○	○	12.250,00 €	<input type="checkbox"/>
Air conditioning 16.000 BTU, salon (incl. outlet for bunkbed D2) incl. 2nd shore power (220 V / 110 V, only with generator) (not in combination with hot air heating)	○	○	5.650,00 €	<input type="checkbox"/>
<b>Interior Equipment – Heating</b>				
Hot air heating, 2 x 4 kW, outlets in salon and cabins, fuelling via diesel tank (not in combination with air conditioning)	○	○	7.950,00 €	<input type="checkbox"/>
<b>Electrical Systems</b>				
230 V Inverter 2500 W (true sine wave)	○	○	2.700,00 €	<input type="checkbox"/>
110 V Inverter 2000 W (true sine wave)	○	○	2.700,00 €	<input type="checkbox"/>
Generator 6.4 kW / 8 kVA, 50 Hz, 230 V	○	○	16.200,00 €	<input type="checkbox"/>
Generator 6.4 kW / 8 kVA, 60 Hz, 110 V	○	○	19.300,00 €	<input type="checkbox"/>
Country version US/JPN	○	○	2.550,00 €	<input type="checkbox"/>
<b>Miscellaneous</b>				
Composite gangway incl. bag and stanchions, foldable, 230 cm	○	○	2.300,00 €	<input type="checkbox"/>
Fresh water dockside inlet	○	○	510,00 €	<input type="checkbox"/>
Cockpit tables cover (only with GRP cockpit table and double cockpit table)	—	○	590,00 €	<input type="checkbox"/>
Steering wheels covers	—	○	575,00 €	<input type="checkbox"/>
<b>Shipment</b>				
Steel cradle for overseas transport	○	○	2.960,00 €	<input type="checkbox"/>
Steel cradle for overseas transport without keel	○	○	3.900,00 €	<input type="checkbox"/>
Shrink wrap	○	○	950,00 €	<input type="checkbox"/>

— Not available    ■ Standard    ○ Optional

Bavaria Yachtbau GmbH, Bavariastraße 1, D-97232 Giebelstadt, Phone +49 9334 942-0, Fax +49 9334 942-1160, www.bavariayachts.com, info@bavariayachts.com

All prices are in EURO and are valid only in conjunction and at the time of ordering a new yacht ex works Giebelstadt. All measurements and weights are calculations based upon design documents. The brochure is intended for advertisement only and is not part of a contract, warranty or of any offer. We reserve the right to modify or improve our products and to change specifications without notice. We are not liable for errors and printing mistakes. Aforementioned prices are recommended sales prices for deliveries ex works within 4 months of order placement. Later deliveries are subject to invoicing according to the then valid price list.

Version: 2/2021

Valid from 1<sup>st</sup> April 2021

Publication: 1<sup>st</sup> April 2021 – The previous price list loses its validity.

Language/Taxes: English/pricelist/all prices excl. VAT

